

Armstrong® TechZone®  
avenue® b



features

Narrow 3" slot T5 fluorescent with satin lens designed for 4" Armstrong® TechZone®.

Shielding options include corrugated, solid regressed trim and flush lens.

Avenue® B is a great solution for general illumination in a narrow aperture.

dimensional data

Regress Trim

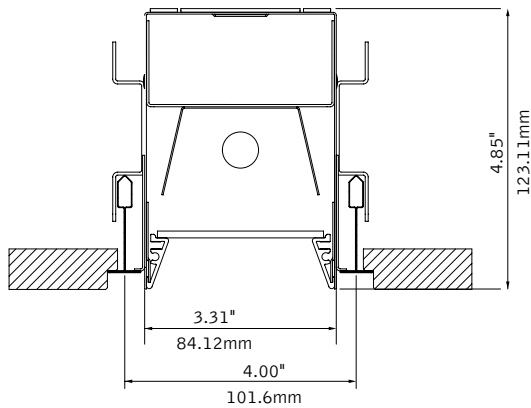

Shielding options

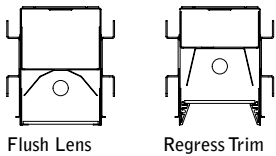

4' example

standard

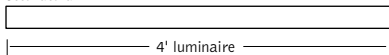

sensor

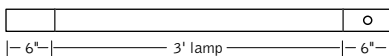

note: Sensors may be installed in any module length. Consult factory for additional placement options.

shielding options

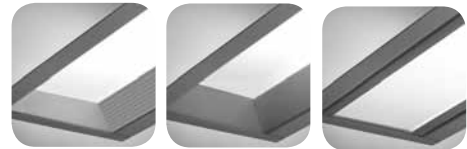

corrugated regress trim

solid regress trim

flush lens



microglow™ lens

companion luminaire

sensor options



mr16

linear

daylight/occupancy sensor

performance

Regressed with lens  
1-Lamp T5  
62% Efficiency  
1466 cd @ 0°

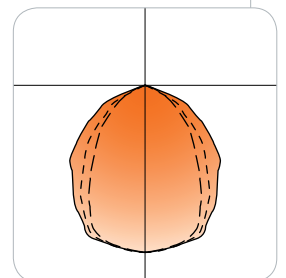

Visit focalpointlights.com for complete photometric data.

october 2011 B

fixture:  
project:

## mounting information

### grid

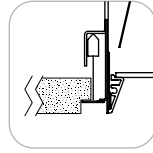
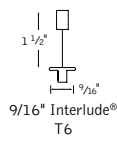
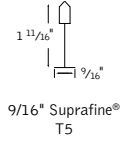

Luminaire always rests at level of tile.

## specifications

### construction

One-piece 20 Ga. steel housing.

Corrugated and solid regress trim constructed of 6063-T5 extruded aluminum finished in Matte Satin White.

20 Ga. steel, .5" wide flange rail finished in Matte Satin White.

2' unit weight:	5 lbs.
3' unit weight:	6 lbs.
4' unit weight:	7 lbs.
5' unit weight:	8 lbs.

### optic

22 Ga. steel reflectors finished in High Reflectance White powder coat.

Frosted Acrylic lens diffuser .118" thick.

Clear Acrylic MicroGlow™ diffuser .125" thick with miniature prismatic pattern.

### electrical

Luminaires are individually wired for specified circuits.

Thru-wiring not available.

Electronic ballasts are thermally protected and have a Class "P" rating.

Optional dimming ballasts available.

Consult factory for dimming specifications and availability.

UL and cUL listed.

### sensors

Lutron daylight sensor is a directional sensor that operates with a Lutron EcoSystem ballast (DB). The sensor has an integrated IR receiver for EcoSystem programming.

Philips Luxsense daylight sensor measures reflected light from the surface below and dims lamp output when the light level exceeds required level. Output may be adjusted by turning the dial. A 0-10V dimming ballast is required (T5/T8 - DS, T5H0 - D7 standard).

Wattstopper daylight sensor is a closed loop system that measures total light level from daylight and electric light. A 0-10V dimming ballast is required (T5/T8 - DS, T5H0 - D7 standard).

Wattstopper occupancy sensor is a passive infrared sensor designed for cubicles and small offices. It has built-in daylight sensing that will hold lights off when adequate ambient light exists. One sensor controls multiple fixtures.

### finish

Polyester powder coat applied over a 5-stage pre-treatment.

## ordering

		<u>FAVBTZ</u>
<b>luminaire series</b>		
Avenue B for Armstrong® TechZone®	FAVBTZ	
<b>shielding</b>		
Corrugated Regressed Trim Frst.Lns	CR	
Solid Regressed Trim Frosted Lens	SR	
Flush Frosted Lens	FL	
Corrugated Regressed Trim with MicroGlow™ Lens	CRM	
Solid Regressed Trim with MicroGlow™ Lens	SRM	
Flush MicroGlow™ Lens	FLM	
<b>lampping</b>		
One Lamp T5	1T5	
One Lamp T5H0	1T5H0	
<b>circuits</b>		<u>1C</u>
Single Circuit	1C	
<b>voltage</b>		
120 Volt	120	
277 Volt	277	
347 Volt	347	
<b>ballast</b>		
Electronic Program Start <10% THD	S	
Electronic Dimming Ballast*	D	
<b>ceiling configurations</b>		
9/16" Suprafine Tegular	T5	
9/16" Interlude Node Tegular	T6	
<b>factory options</b>		
Chicago Plenum	CP	
Emergency Battery Pack* (3' & 4' Luminaires Only)	EM	
Earthquake Clips	EQ	
Flex Whip*	FW	
HLR/GLR Fuse	FU	
Include 3000K Lamp*	L830	
Include 3500K Lamp*	L835	
Include 4100K Lamp*	L841	
Lutron™ Daylight Sensor* (EcoSystem ballast required)	LY1	
Lutron™ Sensor Feed* (EcoSystem ballast required)	SF	
Philips® Daylight Sensor* (0-10V dimming ballast required)	PY1	
WattStopper™ Daylight Sensor* (0-10V dimming ballast required)	WY1	
WattStopper™ Occupancy Sensor*	W01	
<b>finish</b>		<u>WH</u>
Matte White Housing	WH	
<b>luminaire length</b>		
4' Nominal Housing	4'	
5' Nominal Housing (Dimming not available with 5' lamps)	5'	
<b>remotes</b> (specify quantity)		
WattStopper™ Daylight Setup Remote* (required for daylight programming, one included per order)	WYSR	
WattStopper™ Occupant Controller*	WOR	

\* for more information see Reference section.

# regress with lens avenue® b

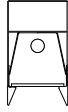

Filename: FAVBSR1T5H0.IES  
 Catalog #: FAVB-SR-1T5H0-1C-120-S-G1-WH-4'  
 Efficiency: 62%  
 Test #: 12914.0

## CANDLEPOWER DISTRIBUTION

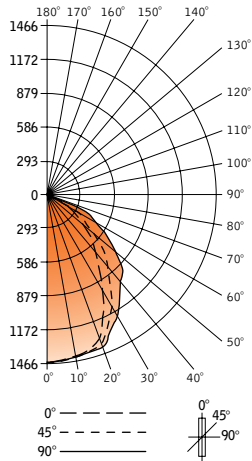

Spacing 1.2  
 Criterion: 1.1

Vertical Angle	Horizontal Angle				Zonal Lumens
	0°	22.5°	45°	67.5°	
0°	1466	1466	1466	1466	1466
5°	1457	1457	1456	1456	139
15°	1432	1428	1417	1399	401
25°	1311	1299	1254	1187	575
35°	1102	1073	958	837	599
45°	934	866	701	586	565
55°	649	578	426	357	416
65°	404	328	232	187	257
75°	184	133	77	60	103
85°	39	21	19	18	24
90°	0	0	0	0	0
95°	0	0	0	0	0
105°	0	0	0	0	0
115°	0	0	0	0	0
125°	0	0	0	0	0
135°	0	0	0	0	0
145°	0	0	0	0	0
155°	0	0	0	0	0
165°	0	0	0	0	0
175°	0	0	0	0	0
180°	0	0	0	0	0

## LUMEN SUMMARY

Zone	Lumens	% Lamp	% Fixt
0°-30°	1115	22.3	36.2
0°-40°	1714	34.3	55.7
0°-60°	2695	53.9	87.5
0°-90°	3078	61.6	100.0
<b>Total Luminaire</b>	<b>3078</b>	<b>62</b>	<b>100.0</b>

## LUMINANCE DATA (CD/M<sup>2</sup>)

Vertical Angle	0°	45°	90°
45°	16467	12359	9750
55°	14106	9259	7281
65°	11918	6844	5133
75°	8863	3709	2794
85°	5579	2718	2432

## CO-EFFICIENTS OF UTILIZATION

Floor	80			70			20					
Ceiling	70	50	30	10	70	50	10	50	10	30	10	00
Wall	70	50	30	10	70	50	10	50	10	30	10	00
RCR 0	73	73	73	73	72	72	72	68	68	65	65	62
1	68	66	64	62	67	65	61	62	59	60	57	54
2	63	59	56	53	62	58	52	56	51	54	50	48
3	59	53	49	46	57	52	45	51	45	49	44	42
4	54	48	43	40	59	47	40	46	39	45	39	37
5	50	43	38	35	49	42	34	41	34	40	34	32
6	46	39	34	31	45	39	30	37	30	36	30	29
7	43	35	31	27	42	35	27	34	27	33	27	25
8	40	32	27	24	39	32	24	31	24	30	23	22
9	37	29	24	21	36	29	21	28	21	27	21	19
10	34	26	22	19	33	26	19	25	18	25	18	17

Numbers indicate percentage values of reflectivity.

Go to [www.focalpointlights.com](http://www.focalpointlights.com) for additional photometric data.

# flush lens avenue® b

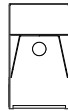

Filename: FAVBFL1T5.IES  
 Catalog #: FAVB-FL-1T5H0-1C-120-S-G1-WH-4'  
 Efficiency: 65%  
 Test #: 13734.0

## CANDLEPOWER DISTRIBUTION

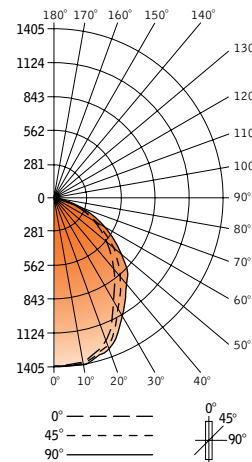

Spacing 1.2  
 Criterion: 1.0

Vertical Angle	Horizontal Angle				Zonal Lumens
	0°	22.5°	45°	67.5°	
0°	1397	1397	1397	1397	1397
5°	1395	1395	1394	1391	1392
15°	1361	1357	1342	1329	1324
25°	1242	1228	1192	1159	1145
35°	1029	1005	950	903	885
45°	8446	812	747	700	684
55°	580	550	501	471	464
65°	356	338	310	297	293
75°	165	158	150	144	142
85°	35	37	38	38	40
90°	0	0	0	0	0
95°	0	0	0	0	0
105°	0	0	0	0	0
115°	0	0	0	0	0
125°	0	0	0	0	0
135°	0	0	0	0	0
145°	0	0	0	0	0
155°	0	0	0	0	0
165°	0	0	0	0	0
175°	0	0	0	0	0
180°	0	0	0	0	0

## LUMEN SUMMARY

Zone	Lumens	% Lamp	% Fixt
0°-30°	1066	21.3	33.0
0°-40°	1665	33.3	51.6
0°-60°	2709	54.2	84.0
0°-90°	3225	64.5	100.0
<b>Total Luminaire</b>	<b>3225</b>	<b>64.5</b>	<b>100.0</b>

## LUMINANCE DATA (CD/M<sup>2</sup>)

Vertical Angle	0°	45°	90°
45°	19577	17286	15828
55°	16546	14293	13237
65°	13784	12003	11344
75°	10432	9483	8977
85°	6571	7134	7510

## CO-EFFICIENTS OF UTILIZATION

Floor	80			70			20					
Ceiling	70	50	30	10	70	50	10	50	10	30	10	00
Wall	70	50	30	10	70	50	10	50	10	30	10	00
RCR 0	77	77	77	77	75	75	75	72	72	69	69	65
1	71	69	66	64	70	67	63	64	61	62	59	56
2	66	61	57	54	64	60	53	58	52	56	51	49
3	61	55	50	46	59	54	46	52	45	50	44	42
4	56	49	44	40	55	48	40	47	39	45	39	37
5	51	44	38	34	50	43	34	42	34	41	34	32
6	48	40	34	30	46	39	30	38	30	37	30	28
7	44	36	30	27	43	35	27	34	26	33	26	25
8	43	32	27	23	40	32	23	31	23	30	23	22
9	37	29	24	20	37	29	20	28	20	27	20	19
10	35	26	21	18	34	26	18	25	18	25	18	17

Numbers indicate percentage values of reflectivity.

Go to [www.focalpointlights.com](http://www.focalpointlights.com) for additional photometric data.