

wall mount
avenue® c

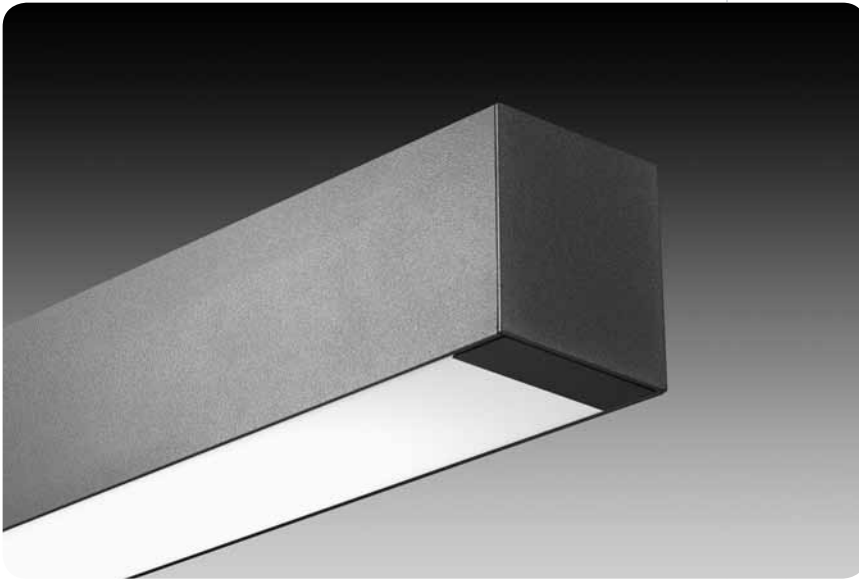

features

Extruded aluminum, wall mount T5/T5HO fluorescent luminaire.

3.5" miniature square profile creates sleek aesthetic.

Luminaire may be specified in a direct or indirect configuration.

Avenue® C makes an exceptional aesthetic statement in conference rooms, private offices, reception areas or other high-end applications.

shielding options



flush opal
satin lens

concave
parabolic louver

solid
(indirect)

companion luminaire

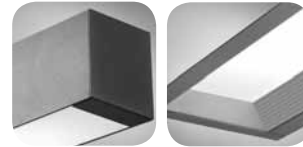

suspended

recessed

dimensional data

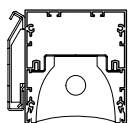
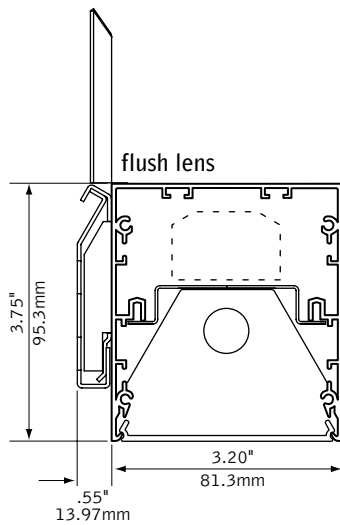

louver

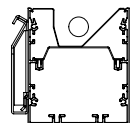

solid (indirect)

fixture information

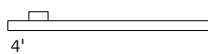

4'

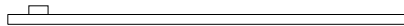

8'

note: j-box cover will be visible.

performance

Indirect with Solid Housing
1-Lamp T5
75% Efficiency
749 cd @ 175°

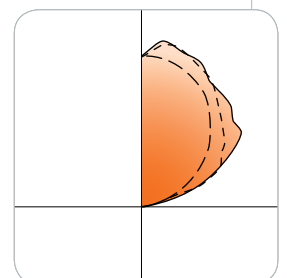

Visit focalpointlights.com for complete photometric data.

fixture:

project:

mounting information

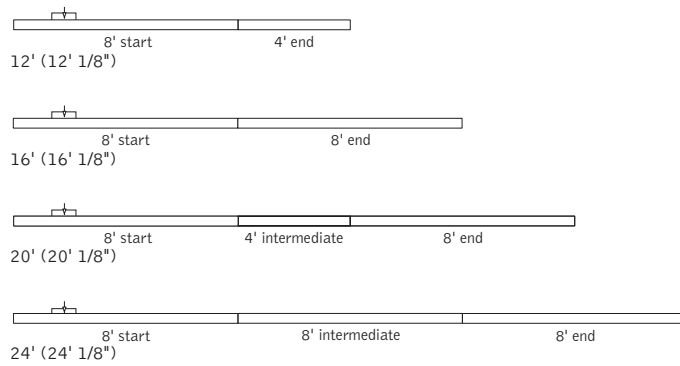

†Power feed location is 24" from left edge of luminaire. J-box cover will be visible.
 Consult factory for additional row length information.
 Maximum continuous run length 56'.

specifications

construction

One-piece, .050" thick housing of 6063-T5 extruded aluminum.
 20 Ga. ballast channel.
 16 Ga. internal bulkhead.
 14 Ga. steel end caps.
 18 Ga. steel rail and brackets.
 Standard lengths are available in 48" and 96".
 All luminaires are provided with mounting brackets.

4' unit weight: 15 lbs
 8' unit weight: 28 lbs

optic

22 Ga. reflector finished in high reflectance white.
 Concave parabolic louver: 1" H x 1" frequency fabricated of low iridescent, semi-specular premium grade aluminum.
 Flush lens: extruded DR™ acrylic lens. 156" thick with opal satin finish.

electrical

Luminaires are pre-wired with factory installed branch circuit wiring and over-molded quick connects.
 Electronic ballasts are thermally protected and have a Class "P" rating.
 Consult factory for dimming specifications and availability.
 UL and cUL listed.

finish

Polyester powder coat applied over a 5-stage pre-treatment.
 Mounting brackets, rail and J-Box plate finished in Matte Satin White.

ordering

luminaire series	FAVCW	<u> </u>
Avenue C	FAVCW	
shielding		<u> </u>
Flush Satin Lens	FL	
Concave Parabolic Louver	PL	
White Concave Parabolic Louver	PW	
Indirect with Solid Housing	SD	
lampping		<u> </u>
One Lamp T5	1T5	
One Lamp T5H0	1T5H0	
circuits		<u> 1C </u>
Single Circuit	1C	
voltage		<u> </u>
120 Volt	120	
277 Volt	277	
347 Volt	347	
ballast		<u> </u>
Electronic Program Start <10% THD	S	
Electronic Dimming Ballast*	D	
mounting		<u> WM </u>
Wall Mount	WM	
factory options		<u> </u>
Opal Acrylic Dust Cover	DC	
Emergency Circuit*	EC	
Emergency Battery Pack*	EM	
HLR/GLR Fuse	FU	
Include 3000K Lamp	L830	
Include 3500K Lamp	L835	
Include 4100K Lamp	L841	
finish		<u> </u>
Matte White Housing	WH	
Titanium Silver	TS	
luminaire length		<u> </u>
4' Nominal Housing	4'	
8' Nominal Housing	8'	
12' (8'+4')	12'	
16' (8'+8')	16'	
20' (8'+4'+8')	20'	
24' (8'+8'+8')	24'	
(Consult factory for custom lengths) (Maximum continuous run length 56')		

* for more information see Reference section.

wall mount with flush lens avenue® c



Filename: FAVCWFLT5.IES
 Catalog #: FAVCW-FL-1T5-1C-120-S-WM-WH-4'
 Efficiency: 59%
 Test #: 12397.2

CANDLEPOWER DISTRIBUTION

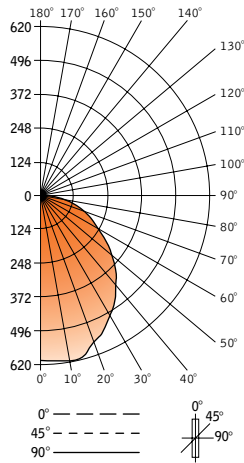

Spacing 1.3
 Criterion: 1.3

Vertical Angle	Horizontal Angle				Zonal Lumens
	0°	22.5°	45°	67.5°	
0°	610	610	610	610	610
5°	613	613	613	613	611
15°	616	616	616	615	175
25°	559	558	556	553	257
35°	490	489	487	484	306
45°	405	403	402	399	311
55°	304	302	299	299	269
65°	206	204	201	200	200
75°	110	108	108	107	114
85°	29	29	25	22	28
90°	0	0	0	0	0
95°	0	0	0	0	0
105°	0	0	0	0	0
115°	0	0	0	0	0
125°	0	0	0	0	0
135°	0	0	0	0	0
145°	0	0	0	0	0
155°	0	0	0	0	0
165°	0	0	0	0	0
175°	0	0	0	0	0
180°	0	0	0	0	0

LUMEN SUMMARY

Zone	Lumens	% Lamp	% Fixt
0°-30°	490	16.9	28.5
0°-40°	796	27.4	46.3
0°-60°	1376	47.5	80.1
0°-90°	1718	59.3	100.0
Total Luminaire	1718	59.3	100.0

LUMINANCE DATA (CD/M²)

Vertical Angle	0°	45°	90°
45°	7474	7418	7363
55°	6916	6802	6779
65°	6360	6206	6113
75°	5546	5445	5445
85°	4342	3743	3144

CO-EFFICIENTS OF UTILIZATION

Floor	80			70			20					
Ceiling	70	50	30	10	70	50	10	50	10	30	10	00
Wall	70	50	30	10	70	50	10	50	10	30	10	00
RCR 0	71	71	71	71	69	69	69	66	66	63	63	59
1	65	62	60	58	63	61	57	59	55	56	54	51
2	60	55	51	48	58	54	48	52	46	50	45	43
3	55	49	44	41	53	48	40	46	40	45	39	37
4	50	44	39	35	49	43	35	41	34	40	34	32
5	46	39	33	30	45	38	29	37	29	35	29	27
6	42	35	29	26	41	34	26	33	25	32	25	24
7	39	31	26	22	38	31	22	30	22	29	22	21
8	36	28	23	19	35	27	19	27	19	26	19	18
9	33	25	20	17	32	25	17	24	17	23	17	15
10	31	23	18	15	30	22	15	22	15	21	15	14

Go to www.focalpointlights.com for additional photometric data.

Numbers indicate percentage values of

wall mount with lower avenue® c



Filename: FAVCWPL1T5H.IES
 Catalog #: FAVCW-PL-1T5H0-1C-120-S-WM-WH-4'
 Efficiency: 54%
 Test #: 12387.2

CANDLEPOWER DISTRIBUTION

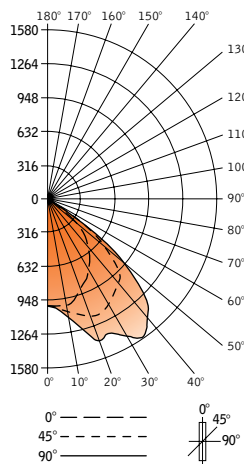

Spacing 1.1
 Criterion: 1.9

Vertical Angle	Horizontal Angle				Zonal Lumens
	0°	22.5°	45°	67.5°	
0°	1012	1012	1012	1012	1012
5°	1017	1024	1030	1037	1041
15°	984	1026	1127	1235	1279
25°	849	940	1188	1330	1386
35°	681	861	1107	1404	1583
45°	473	646	957	1165	1326
55°	115	202	381	446	392
65°	18	24	35	55	44
75°	7	8	9	9	11
85°	1	1	1	2	2
90°	0	0	0	0	0
95°	0	0	0	0	0
105°	0	0	0	0	0
115°	0	0	0	0	0
125°	0	0	0	0	0
135°	0	0	0	0	0
145°	0	0	0	0	0
155°	0	0	0	0	0
165°	0	0	0	0	0
175°	0	0	0	0	0
180°	0	0	0	0	0

LUMEN SUMMARY

Zone	Lumens	% Lamp	% Fixt
0°-30°	948	19.0	35.1
0°-40°	1655	33.1	61.3
0°-60°	2653	53.1	98.3
0°-90°	2700	54.0	100.0
Total Luminaire	2700	54.0	100.0

LUMINANCE DATA (CD/M²)

Vertical Angle	0°	45°	90°
45°	8729	17660	2447
55°	2616	8668	8918
65°	556	1081	1359
75°	353	454	555
85°	150	150	299

CO-EFFICIENTS OF UTILIZATION

Floor	80			70			20					
Ceiling	70	50	30	10	70	50	10	50	10	30	10	00
Wall	70	50	30	10	70	50	10	50	10	30	10	00
RCR 0	64	64	64	64	63	63	63	60	60	57	57	54
1	61	59	57	56	59	58	55	55	53	53	52	49
2	57	54	51	49	56	53	48	51	47	49	46	44
3	53	49	46	43	52	48	43	47	42	45	41	40
4	49	44	41	38	48	44	38	42	37	41	37	35
5	46	40	36	33	45	40	33	38	33	37	32	31
6	42	36	32	29	41	36	29	35	29	34	29	28
7	39	33	29	26	38	32	26	32	25	31	25	24
8	36	29	25	22	35	29	22	28	22	28	22	21
9	33	26	22	19	32	26	19	25	19	25	19	18
10	30	24	20	17	30	23	17	23	17	22	17	16

Go to www.focalpointlights.com for additional photometric data.

Numbers indicate percentage values of

solid wall mount
avenue® c



Filename: FAVCWS1T5.IES
 Catalog #: FAVCW-SD-1T5-1C-120-S-WM-WH-4'
 Efficiency: 75%
 Test #: 26963

CANDLEPOWER DISTRIBUTION

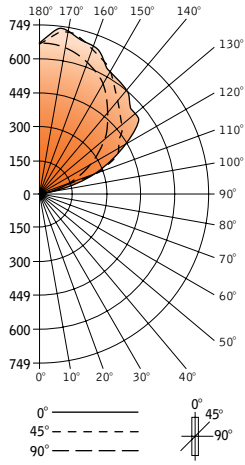

Vertical Angle	Horizontal Angle				Zonal Lumens	
	0°	22.5°	45°	67.5°		
0°	0	0	0	0	0	
5°	0	0	0	0	0	
15°	0	0	0	0	0	
25°	0	0	0	0	0	
35°	0	0	0	0	0	
45°	0	0	0	0	0	
55°	0	0	0	0	0	
65°	0	0	0	0	0	
75°	0	0	0	0	0	
85°	0	0	0	0	0	
90°	0	0	0	0	0	
95°	21	1	1	2	2	
105°	122	29	3	3	13	
115°	240	132	52	16	8	41
125°	365	281	152	10	88	85
135°	480	435	308	221	199	126
145°	586	578	472	402	375	150
155°	671	652	631	577	557	142
165°	722	696	712	719	712	99
175°	749	731	724	723	719	35
180°	748	748	748	748	748	

LUMEN SUMMARY

	Zone Lumens	% Lamp	% Fixt
0°-30°	0	0	0
0°-90°	0	0	0
90°-180°	1945	74.8	100.0
Total Luminaire	0°-180° 1945	74.8	100.0

CO-EFFICIENTS OF UTILIZATION

Floor														
Ceiling	80	70		50	30	10	00							
Wall	70	50	30	10	50	10	50	10	00					
RCR	0	71	71	71	71	42	4	24	4	8	8	0		
1	65	62	59	57	55	53	48	36	34	21	20	7	6	0
2	59	54	50	46	50	46	40	32	29	18	16	6	5	0
3	54	47	42	38	46	40	33	28	23	16	14	5	4	0
4	49	42	36	32	42	36	8	25	20	14	12	5	4	0
5	45	36	31	27	38	32	24	22	17	13	10	4	3	0
6	41	33	27	23	35	28	20	19	14	11	9	4	3	0
7	38	29	24	20	32	25	17	17	12	10	7	3	2	0
8	35	26	21	17	30	23	15	16	11	9	6	3	2	0
9	32	24	19	15	27	20	13	14	9	8	6	3	2	0
10	30	22	17	13	25	19	12	13	8	8	5	2	2	0

Numbers indicate percentage values of reflectivity.

Go to www.focalpointlights.com for additional photometric data.