

downlight – pinhole
id®

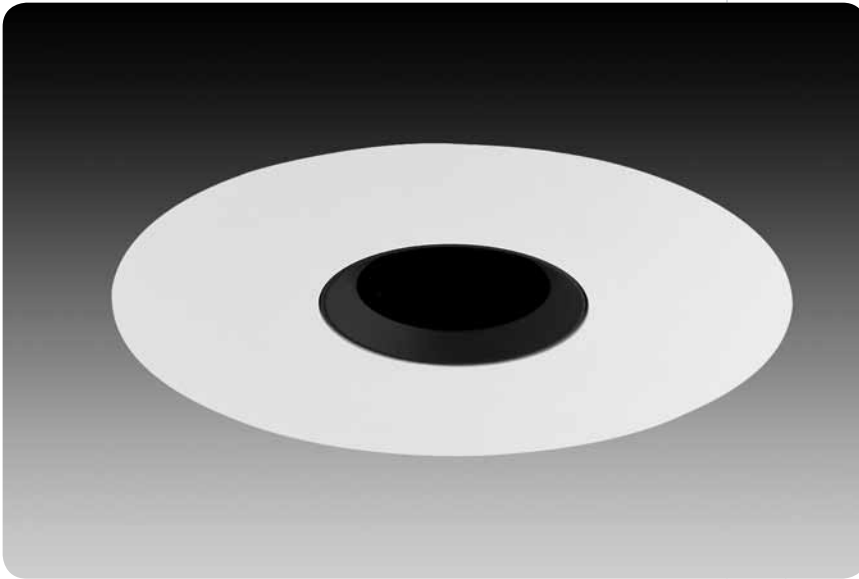

Covered by US Patent: 7,748,868

features

Downlight pinhole offers a parabolic 50 degree cutoff in a simple straight down aiming position.

Perfect Fit™ installation process provides seamless integration in plaster, drywall and acoustical tiles, while maintaining optics in any ceiling thickness.

Trim provides for easy relamping.

Smart Lock™ ring allows quick removal and re-assembly of trim components for field painting.

Standard white finish is field paintable.

Interchangeable lamp and trim mechanisms allow for maximum flexibility, even after luminaire is installed.

trim assembly

trim

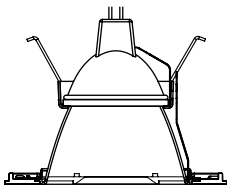

flush trim
(drywall only)

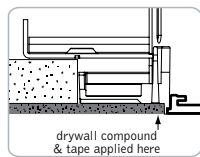
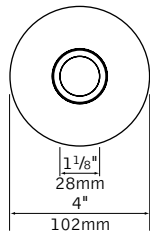

ceiling cutout dimensions:
6 3/16"

overlap trim

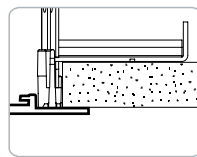
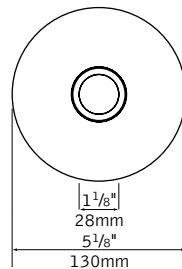

ceiling cutout dimensions:
T & IC Housings - 4 11/16"
RT Housing - 4 5/8"

housing types

T

14" x 7.625" x 5"h

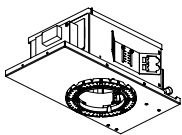

IC (air-tight)

16.5" x 10" x 9"h

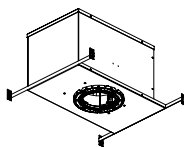

RT

11.64" x 6.59" x 5.58"h

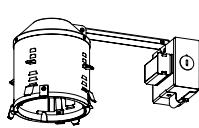

overlap faceplate only

trim option



trim without
black bevel

lens accessories

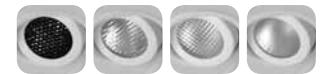

hex louver linear prismatic sand blasted

performance

Downlight Pinhole with Black Bevel
Q71MR16/C/NSP15
4027 cd @ 0° (0° tilt)

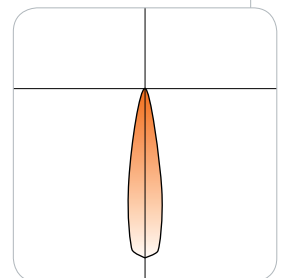

Visit focalpointlights.com for complete photometric data.

fixture:

project:

housing specifications

lamp

Halogen MR16 lamp provides numerous beam options from 10° to 40°.

construction

(T)Thermally protected housing for new construction applications without direct contact with insulation. Insulation to be kept 3" away from housing. Unit is enclosed in 20ga. black painted CRS housing, which eliminates stray light into the plenum, on a 20ga. CRS frame. Housing ships standard with butterfly brackets which mount to ½ emt or channel and vertically adjust 2". Bar hangers are an option and must be specified when ordering T-rated housing. Transformer is accessible from below ceiling. Unit may be relamped from above. Fixture will not exceed 7.5lbs.

(IC) Insulated ceiling housing for new construction applications with direct insulation contact. Unit is constructed of double wall 18ga. aluminum housing on a 20ga. CRS frame. Housing ships standard with locking bar hangers. Transformers and thermal protectors are accessible from below ceiling. Housing is gasketed and complies with ASTM E-283, air-tight energy codes. Fixture will not exceed 11lbs.

(RT)Remodel, thermally protected housing for remodel construction applications without direct contact with insulation. Insulation to be kept 3" away from housing. Unit is 20ga. black painted CRS with contoured top and hinging J-box arm. Housing locks into finished ceiling via 4 removable spring clips. J-box and transformers are accessible by removing housing from ceiling. Fixture will not exceed 4.5lbs.

electrical

Porcelain bi-pin socket with quick connection.

Acoustically isolated transformer, replaceable from below, mounted outside of housing to ensure cool operation and minimize hum. Transformers available in either electronic or magnetic 120V or 277V. For residential dimming applications, toroidal magnetic transformer is available. Large junction box with pryouts. UL listed for thru branch wiring, four #12 90°C conductors for T housing and two #14 90°C conductors for RT and IC housing.

installation

Adjustable throat allows infinite adjustment for ½" to 1½" thick ceilings. Shipped in ½" ceiling position. For thicker ceilings consult factory.

Ceiling thickness adjustment sleeve locks with supplied ⅜" hex driver.

Sleeve allows fine tuning of the housing for a perfect fit. Comes with laser/string alignment guides.

Housing ships with dust cover.

trim specifications

aesthetics

Diminutive black knife edge baffle minimizes brightness. Truncated Specular black reflector cone above ensures glare free optics. Reflector is .040" spun aluminum. Matte white finish may be used as a primer coat for field painting. Smart Lock™ ring allows disassembly for custom field painting.

optics

50° cutoff to the lamp and the lamp image.

construction

Torsion springs pull trim tight to the ceiling.

Auto Memory for relamping, keeps lamp in a straight down aiming position.

Trim stays captive to housing during relamping via torsion springs.

Tempered soft focus lens supplied as standard.

Lamp tray can hold up to two accessories, up to ¼" thick.

No visible fasteners within the trim.

Mechanical light traps eliminate light leaks.

Warp free die-cast aluminum faceplate, .040" thick flange on overlap versions.

Installation clip allows Downlight Pinhole to be used in basic housing. Removable clips slide and lock into place to dedicate fixture to downlight use only.

labels

UL listed, Damp label standard.

No visible labels when trim is installed.

housing ordering

housing series FD4

Halogen Housing FD4

lamp MR

MR16 Lamp MR

transformer type _____

Electronic Dimming 120V, 11.7V E1

Electronic Dimming 277V, 11.7V E2

Magnetic Dimming 120V, 11.7V M1
(T housings only)

Magnetic Dimming 277V, 11.7V M2
(T housings only)

Toroidal Dimming 120V M1T
(IC & RT housings only)

faceplate type _____

Round Flush RF
(T & IC housings only)

Round Overlap RO

housing type _____

(T Rated: 71W max.
IC Rated & Remodel: 50W max.)

New Construction T Rated, T
up to 1½" ceilings

New Construction T Rated, T2
1½" to 2½" ceilings

New Construction T Rated, T3
2½" to 3½" ceilings

New Construction IC Rated, IC
up to 1½" ceilings

New Construction IC Rated, IC2
1½" to 2½" ceilings

New Construction IC Rated, IC3
2½" to 3½" ceilings

Remodel T Rated RT
(overlap faceplate only)

factory options _____

Bar Hangers BH
(T housings only)

Wattage Restriction Label WRXX
(XX=wattage)

Chicago Plenum CP
(T housings only)

trim ordering

trim aperture D1

1½" Aperture D1

faceplate type _____

Round Flush RF
(T & IC housing only) (drywall only)

Round Overlap RO

optic _____

Pinhole with Black Bevel PINF

Pinhole without Black Bevel PINXF

faceplate finish _____

White WH

Black BK

Titanium Silver TS

Aluminum Raw AL

lens accessories _____

(soft focus lens supplied as standard)

Hex Louver HL

Linear Spread Lens LSL

Prismatic Spread Lens PSL

Sand Blasted Lens SBL

Clear Lens CL

UV Lens UVL

a complete unit consists of two line items, housing and trim
example: FD4-MR-E1-RF-IC / D1-RF-PINF-WH

rnd downlight – pinhole
id®



Luminaire: 71W MR16 accent pinhole, narrow spot distribution with micropismatic lens
 Filename: D1RXPINHA71NS15_0.ies
 Catalog #: D1-RX-PINF-WH
 Efficiency: 48% (0° tilt) , 37% (30° tilt)
 Photometric Report #: 13547.0

CANDLEPOWER DISTRIBUTION - 0° TILT

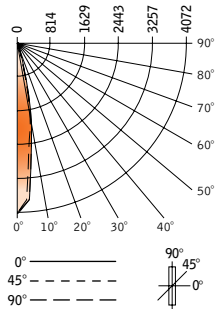

Vertical Angle	Horizontal Angle			
	0°	22.5°	45°	67.5° 90°
0°	4072	4072	4072	4072 4072
5°	3691	3702	3744	3698 3670
15°	645	770	797	792 636
25°	81	112	107	77 47
35°	10	14	13	8 6
45°	2	3	2	0 0
55°	0	0	0	0 0
65°	0	0	0	0 0
75°	0	0	0	0 0
85°	0	0	0	0 0
90°	0	0	0	0 0

FOOTCANDLE VALUES

0° aiming angle - horizontal surface

D	C	FC	L	W
6'	0	114	1.6'	1.6'
8'	0	64	2.1'	2.1'
10'	0	41	2.6'	2.6'
12'	0	28	3.2'	3.2'
14'	0	21	3.7'	3.7'

Footcandle results based on AGI32; off the shelf lamp in fixture, with soft focus lens; Reflectances=0/0/0; LLF=1

Go to www.focalpointlights.com for additional photometric data.