

0-45° accent – pinhole with lens  
id®

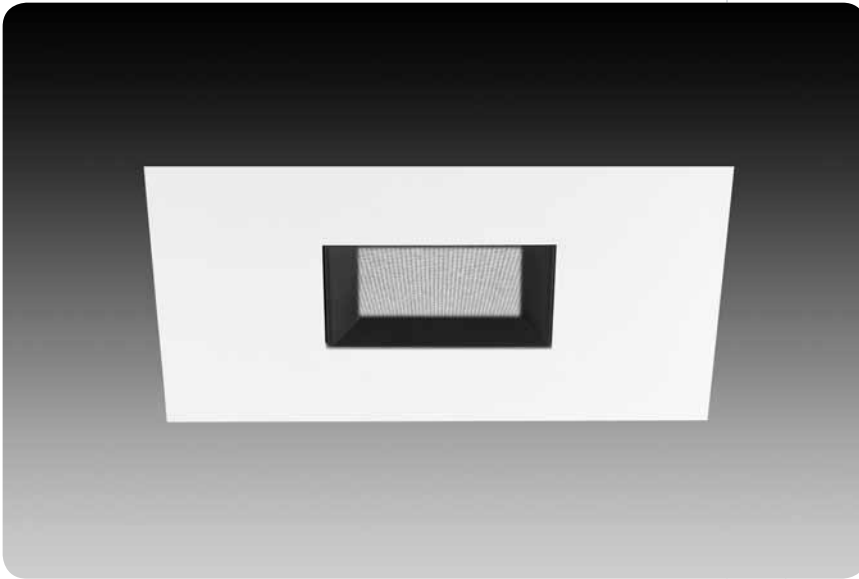

Covered by US Patent: 7,748,868

features

Trims available in Overlap flange or Flush mud-in for a seamless appearance.

Gloves Off™ hot aiming made simple with gear drive for both 45° vertical and 363° horizontal adjustment; Self locking.

Auto Memory remembers original lamp position after relamping. Lenses are independent of lamp, and remain undisturbed during relamping.

Perfect Fit™ installation process provides seamless integration in plaster, drywall and acoustical tiles, while maintaining optics in any ceiling thickness.

Adjustment mechanism provides for:

- easy relamping
- locking of both vertical and horizontal aiming
- lowers for easy lamp and lens access.

Smart Lock™ ring allows quick removal and re-assembly of trim components for field painting.

Standard white finish is field paintable.

Interchangeable lamp and trim mechanisms allow for maximum flexibility, even after luminaire is installed.

lens accessories



trim assembly

trim with adjustment mechanism

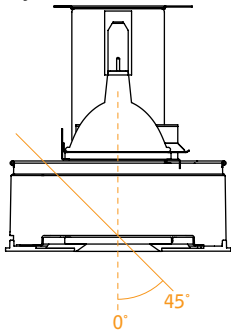

flush trim (drywall only)

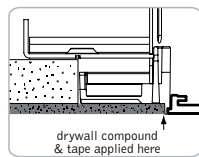
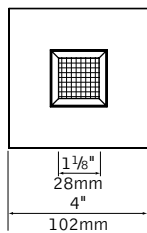

ceiling cutout dimensions: 6 3/16"

overlap trim

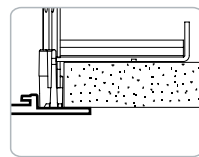
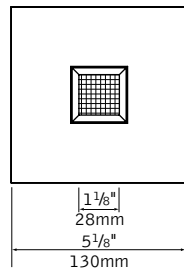

ceiling cutout dimensions:  
T & IC Housings - 4 11/16"  
RT Housing - 4 5/8"

housing types

T

14" x 7.625" x 5" h

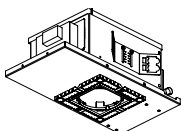

IC (air-tight)

16.5" x 10" x 9" h

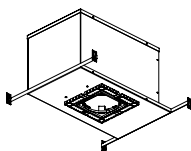

RT

12.08" x 6.32" x 5.58" h

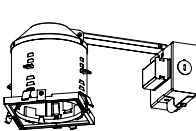

overlap faceplate only

performance

Accent Pinhole with Lens  
Q71MR16/C/NSP15  
4540 cd @ 0° (0° tilt)

For optimal performance, rotate lamp on axis to 0°, 90°, 180° or 270°.

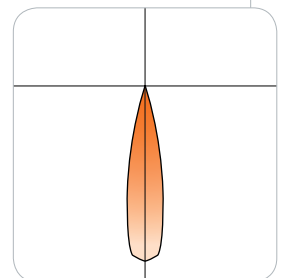

Visit focalpointlights.com for complete photometric data.

fixture:

project:

## housing specifications

### lamp

Halogen MR16 lamp provides numerous beam options from 10° to 40° (60° not recommended).

### construction

(T)Thermally protected housing for new construction applications without direct contact with insulation. Insulation to be kept 3" away from housing. Unit is enclosed in 20ga. black painted CRS housing, which eliminates stray light into the plenum, on a 20ga. CRS frame. Housing ships standard with butterfly brackets which mount to ½ emt or channel and vertically adjust 2". Bar hangers are an option and must be specified when ordering T-rated housing. Transformer is accessible from below ceiling. Unit may be relamped from above. Fixture will not exceed 7.5lbs.

(IC) Insulated ceiling housing for new construction applications with direct insulation contact. Unit is constructed of double wall 18ga. aluminum housing on a 20ga. CRS frame. Housing ships standard with locking bar hangers. Transformers and thermal protectors are accessible from below ceiling. Housing is gasketed and complies with ASTM E-283, air-tight energy codes. Fixture will not exceed 11lbs.

(RT)Remodel, thermally protected housing for remodel construction applications without direct contact with insulation. Insulation to be kept 3" away from housing. Unit is 20ga. black painted CRS with contoured top and hinging J-box arm. Housing locks into finished ceiling via 4 removable spring clips. J-box and transformers are accessible by removing housing from ceiling. Fixture will not exceed 4.5lbs.

### electrical

Porcelain bi-pin socket with #18 Teflon leads with keyed quick connection. Acoustically isolated transformer, replaceable from below, mounted outside of housing to ensure cool operation and minimize hum. Transformers available in either electronic or magnetic 120V or 277V. For residential dimming applications, toroidal magnetic transformer is available. Large junction box with pryouts. UL listed for thru branch wiring, four #12 90°C conductors for T housing and two #14 90°C conductors for RT and IC housing.

### installation

Adjustable throat allows infinite adjustment for ½" to 1½" thick ceilings. Shipped in ½" ceiling position. For thicker ceilings consult factory.

Ceiling thickness adjustment sleeve locks with supplied ⅜" hex driver. Sleeve allows fine tuning of the housing for a perfect fit. Square housing allows 45° rotation to square up the edges of the trim with the architecture and adjacent trims. Comes with laser/string alignment guides.

Housing ships with dust cover.

## trim specifications

### aesthetics

Diminutive black knife edge baffle minimizes brightness. Patterned glass above baffle provides smooth wash of light and does not show water spots. Glass is spring loaded for ease in releasing trim for aiming and relamping.

Matte white finish may be used as a primer coat for field painting. Smart Lock™ ring allows disassembly for custom field painting.

### adjustment mechanism

Auto Memory for relamping, lamp returns to preset aiming position.

Mechanism is matte black finish, and holds lamp and lenses independently. Hot aiming with Philips screwdriver allows 45° vertical tilt, and 363° rotation and locks into position. Mechanism pulls down for quick and easy relamping.

Vertical angle and horizontal rotation indicators display positioning. For optimal performance, rotate lamp on axis to 0°, 90°, 180° or 270°.

Tempered soft focus lens supplied as standard.

Lens tray can hold up to three accessories, up to ⅜" thick. Lens remain undisturbed during relamping.

### optics

50° cutoff to the lamp and lamp image.

Tempered 2" diameter Solite lens held over aperture via radial spring.

### construction

Trim stays captive to housing during relamping via torsion springs.

Torsion springs pull trim tight to the ceiling.

No visible fasteners within the trims

Mechanical light traps eliminate light leaks

Warp free die-cast aluminum faceplate, .040" thick flange on overlap versions.

### labels

UL listed, Wet label standard.

No visible labels when trim is installed.

## housing ordering

housing series FD4

Halogen Housing FD4

lamp MR

MR16 Lamp MR

transformer type \_\_\_\_\_

Electronic Dimming 120V, 11.7V E1

Electronic Dimming 277V, 11.7V E2

Magnetic Dimming 120V, 11.7V M1  
(T housings only)

Magnetic Dimming 277V, 11.7V M2  
(T housings only)

Toroidal Dimming 120V M1T  
(IC & RT housings only)

faceplate type \_\_\_\_\_

Square Flush SF  
(T & IC housings only)

Square Overlap SO

housing type \_\_\_\_\_

(T Rated: 71W max.  
IC Rated & Remodel: 50W max.)

New Construction T Rated, T  
up to 1½" ceilings

New Construction T Rated, T2  
1½" to 2½" ceilings

New Construction T Rated, T3  
2½" to 3½" ceilings

New Construction IC Rated, IC  
up to 1½" ceilings

New Construction IC Rated, IC2  
1½" to 2½" ceilings

New Construction IC Rated, IC3  
2½" to 3½" ceilings

Remodel T Rated RT  
(overlap faceplate only)

factory options \_\_\_\_\_

Bar Hangers BH  
(T housings only)

Wattage Restriction Label WRXX  
(XX=wattage)

Chicago Plenum CP  
(T housings only)

## trim ordering

trim aperture D1

1½" Aperture D1

faceplate type \_\_\_\_\_

Square Flush SF  
(T & IC housing only) (drywall only)

Square Overlap SO

optic PL

Pinhole lens with Black Bevel PL

faceplate finish \_\_\_\_\_

White WH

Black BK

Titanium Silver TS

Aluminum Raw AL

lens accessories \_\_\_\_\_

(soft focus lens supplied as standard)

Hex Louver HL

Linear Spread Lens LSL

Prismatic Spread Lens PSL

Sand Blasted Lens SBL

Clear Lens CL

UV Lens UVL

a complete unit consists of two line items, housing and trim  
example: FD4-MR-E1-SF-T / D1-SF-PL-WH

sqr accent – pinhole with lens  
id®



Luminaire: 71W MR16 lensed pinhole downlight, narrow spot distribution with soft focus lens  
 Filename: D1SXPLHA71NS15\_0.ies  
 Catalog #: D1-SX-PL-WH  
 Efficiency: 63%  
 Photometric Report #: 13576.0

CANDLEPOWER DISTRIBUTION

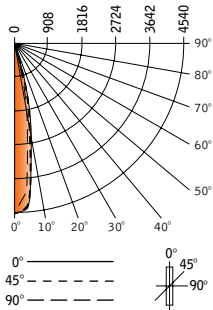

Vertical Angle	Horizontal Angle					Zonal Lumens
	0°	22.5°	45°	67.5°	90°	
0°	4540	4540	4540	4540	4540	
5°	3869	4163	4370	4365	4319	387
15°	879	986	1095	1242	1119	267
25°	96	110	142	137	147	45
35°	20	22	22	18	15	10
45°	13	13	13	8	4	5
55°	0	2	3	0	0	0
65°	0	0	0	0	0	0
75°	0	0	0	0	0	0
85°	0	0	0	0	0	0
90°	0	0	0	0	0	0

LUMEN SUMMARY

Zone	Lumens	% Lamp	% Fixt
0°-30°	699	61.3	97.9
0°-90°	709	62.2	99.2
90°-130°	714	62.6	100
90°-180°	714	62.6	100
Total Luminaire	714	62.6	100

LUMINANCE DATA (CD/M<sup>2</sup>)

Vertical Angle	0°	45°	90°
45°	20172	20172	6207
55°	0	5739	0
65°	0	0	0
75°	0	0	0
85°	0	0	0

FOOTCANDLE VALUES

D	FC	L	W
6'	127	1.6'	1.6'
8'	71	2.1'	2.1'
10'	46	2.6'	2.6'
12'	32	3.2'	3.2'
14'	23	3.7'	3.7'

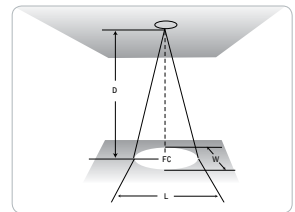

Footcandle results based on AGI32; off the shelf lamp in fixture, with microprismatic lens; Reflectances=0/0/0; LLF=1

Go to [www.focalpointlights.com](http://www.focalpointlights.com) for additional photometric data.