

0-45° accent – reflector
id®



Covered by US Patent: 7,748,868

features

Trims available in Overlap flange or Flush mud-in for a seamless appearance.

Gloves Off™ hot aiming made simple with gear drive for both 45° vertical and 363° horizontal adjustment; Self locking.

Auto Memory remembers original lamp position after relamping. Lenses are independent of lamp, and remain undisturbed during relamping.

Perfect Fit™ installation process provides seamless integration in plaster, drywall and acoustical tiles, while maintaining optics in any ceiling thickness.

Adjustment mechanism provides for:

- easy relamping
- locking of both vertical and horizontal aiming
- lowers for easy lamp and lens access.

Smart Lock™ ring allows quick removal and re-assembly of trim components for field painting.

Standard white finish is field paintable.

Interchangeable lamp and trim mechanisms allow for maximum flexibility, even after luminaire is installed.

reflector options

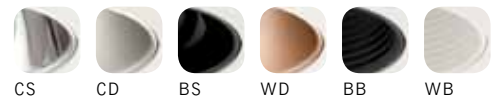

trim assembly

trim with adjustment mechanism

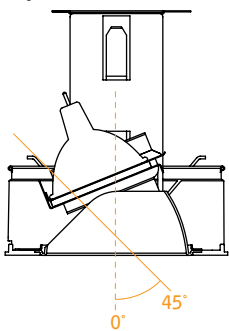

flush trim (drywall only)

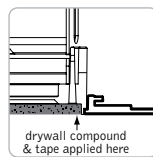
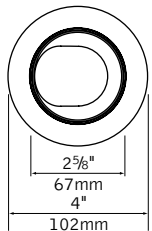

ceiling cutout dimensions: 6 3/16"

overlap trim

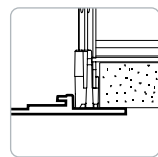
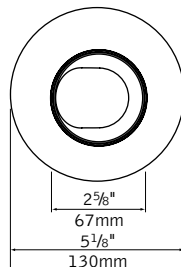

ceiling cutout dimensions: T & IC Housings - 4 11/16" RT Housing - 4 5/8"

housing types

T

14" x 7.625" x 5" h

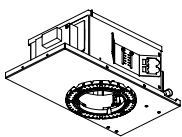

IC (air-tight)

16.5" x 10" x 9" h

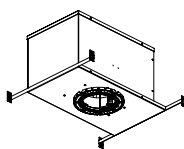

RT

11.64" x 6.59" x 5.58" h

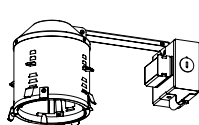

overlap faceplate only

performance

Accent Clear Specular Reflector
Q71MR16/C/NSP15
5694 cd @ 30° (30° tilt)

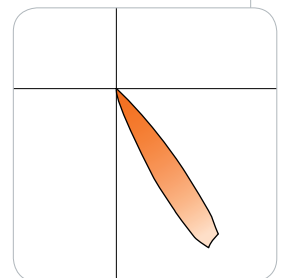

Visit focalpointlights.com for complete photometric data.

fixture:

project:

housing specifications

lamp

Halogen MR16 lamp provides numerous beam options from 10° to 40° (60° not recommended).

construction

(T)Thermally protected housing for new construction applications without direct contact with insulation. Insulation to be kept 3" away from housing. Unit is enclosed in 20ga. black painted CRS housing, which eliminates stray light into the plenum, on a 20ga. CRS frame. Housing ships standard with butterfly brackets which mount to ½ emt or channel and vertically adjust 2". Bar hangers are an option and must be specified when ordering T-rated housing. Transformer is accessible from below ceiling. Unit may be relamped from above. Fixture will not exceed 7.5lbs.

(IC) Insulated ceiling housing for new construction applications with direct insulation contact. Unit is constructed of double wall 18ga. aluminum housing on a 20ga. CRS frame. Housing ships standard with locking bar hangers. Transformers and thermal protectors are accessible from below ceiling. Housing is gasketed and complies with ASTM E-283, air-tight energy codes. Fixture will not exceed 11lbs.

(RT)Remodel, thermally protected housing for remodel construction applications without direct contact with insulation. Insulation to be kept 3" away from housing. Unit is 20ga. black painted CRS with contoured top and hinging J-box arm. Housing locks into finished ceiling via 4 removable spring clips. J-box and transformers are accessible by removing housing from ceiling. Fixture will not exceed 4.5lbs.

electrical

Porcelain bi-pin socket with #18 Teflon leads with keyed quick connection. Acoustically isolated transformer, replaceable from below, mounted outside of housing to ensure cool operation and minimize hum. Transformers available in either electronic or magnetic 120V or 277V. For residential dimming applications, toroidal magnetic transformer is available. Large junction box with pryouts. UL listed for thru branch wiring, four #12 90°C conductors for T housing and two #14 90°C conductors for RT and IC housing.

installation

Adjustable throat allows infinite adjustment for ½" to 1½" thick ceilings. Shipped in ½" ceiling position. For thicker ceilings consult factory.

Ceiling thickness adjustment sleeve locks with supplied ⅝" hex driver.

Sleeve allows fine tuning of the housing for a perfect fit. Comes with laser/string alignment guides.

Housing ships with dust cover.

trim specifications

aesthetics

Slotted reflector cone with Parabolic profile ensures glare free optics. Reflector is .040 spun aluminum. Optional sloped-sided baffle consists of ¼" steps. Black and white baffles are painted finishes. Optics sit flush with the front surface of the faceplate.

Matte white finish may be used as a primer coat for field painting. Smart Lock™ ring allows disassembly for custom field painting.

adjustment mechanism

Auto Memory for relamping, lamp returns to preset aiming position.

Mechanism is matte black finish and holds lamp and lenses independently.

Hot aiming with Philips screwdriver allows for 45° vertical tilt, and 363° rotation and locks into position. Mechanism pulls down for quick and easy relamping.

Vertical angle and horizontal rotation indicators display positioning.

Tempered soft focus lens supplied as standard.

Lens tray can hold up to three accessories, up to ⅜" thick. Lenses remain undisturbed during relamping.

optics

50° cutoff to the lamp and lamp image.

construction

Trim stays captive to housing during relamping via torsion springs.

Torsion springs pull trim tight to the ceiling.

No visible fasteners within the trim.

Mechanical light traps eliminate light leaks.

Warp free die-cast aluminum faceplate, .040" thick flange on overlap versions.

labels

UL listed, Damp label standard.

No visible labels when trim is installed.

housing ordering

housing series	FD4
Halogen Housing	FD4
lamp	MR
MR16 Lamp	MR
transformer type	
Electronic Dimming 120V, 11.7V	E1
Electronic Dimming 277V, 11.7V	E2
Magnetic Dimming 120V, 11.7V (T housings only)	M1
Magnetic Dimming 277V, 11.7V (T housings only)	M2
Toroidal Dimming 120V (IC & RT housings only)	M1T
faceplate type	
Round Flush (T & IC housings only)	RF
Round Overlap	RO
housing type	
(T Rated: 71W max. IC Rated & Remodel: 50W max.)	
New Construction T Rated, up to 1½" ceilings	T
New Construction T Rated, 1½" to 2½" ceilings	T2
New Construction T Rated, 2½" to 3½" ceilings	T3
New Construction IC Rated, up to 1½" ceilings	IC
New Construction IC Rated, 1½" to 2½" ceilings	IC2
New Construction IC Rated, 2½" to 3½" ceilings	IC3
Remodel T Rated (overlap faceplate only)	RT
factory options	
Bar Hangers (T housings only)	BH
Wattage Restriction Label (XX=wattage)	WRXX
Chicago Plenum (T housings only)	CP
trim ordering	
trim aperture	D2
2½" Aperture	D2
faceplate type	
Round Flush (T & IC housing only) (drywall only)	RF
Round Overlap	RO
optic	AA
Adjustable Accent	AA
color	
Clear Specular	CS
Clear Diffuse	CD
Black Specular	BS
Warm Diffuse	WD
Black Baffle	BB
White Baffle	WB
faceplate finish	
White	WH
Black	BK
Titanium Silver	TS
Aluminum Raw	AL
lens accessories (soft focus lens supplied as standard)	
Hex Louver	HL
Linear Spread Lens	LSL
Prismatic Spread Lens	PSL
Sand Blasted Lens	SBL
Clear Lens	CL
UV Lens	UVL

a complete unit consists of two line items, housing and trim
example: FD4-MR-E1-RF-T / D2-RF-AA-CD-WH

rnd accent – reflector
id®

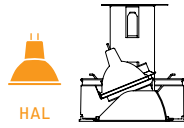

Luminaire: 71W MR16 adjustable accent, narrow spot distribution with soft focus lens
 Filename: D2RXAACSHA71NS15_0.ies and D2RXAACSHA71NS15_30.ies
 Catalog #: D2-RX-AA-CS-WH
 Efficiency: 88% (0° tilt), 85% (30° tilt)
 Photometric Report #: 13555.0 and 13556.0

CANDLEPOWER DISTRIBUTION - 0° TILT

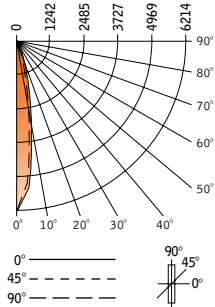

Vertical Angle	Horizontal Angle				
	0°	22.5°	45°	67.5°	90°
0°	6214	6214	6214	6214	6214
5°	4977	5097	5120	5305	5243
15°	1132	1288	1567	1507	1371
25°	267	294	332	346	276
35°	36	47	50	45	31
45°	11	10	11	10	8
55°	1	2	2	2	1
65°	0	0	0	0	0
75°	0	0	0	0	0
85°	0	0	0	0	0
90°	0	0	0	0	0

CANDLEPOWER DISTRIBUTION - 30° TILT

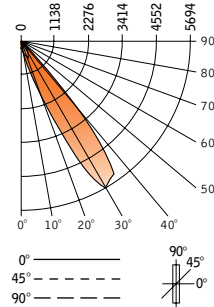

Vertical Angle	Horizontal Angle				
	0°	22.5°	45°	67.5°	90°
0°	244	244	244	244	244
5°	295	292	282	266	250
15°	827	735	456	297	236
25°	3924	2155	637	254	167
35°	5449	1878	359	110	37
45°	1009	415	67	12	5
55°	103	35	4	0	0
65°	7	4	0	0	0
75°	0	0	0	0	0
85°	0	0	0	0	0
90°	0	0	0	0	0

FOOTCANDLE VALUES

0° aiming angle - horizontal surface

D	C	FC	L	W
6'	0	173	1.6'	1.6'
8'	0	97	2.1'	2.1'
10'	0	62	2.6'	2.6'
12'	0	43	3.2'	3.2'
14'	0	32	3.7'	3.7'

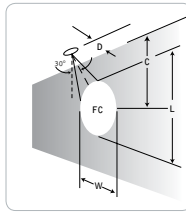
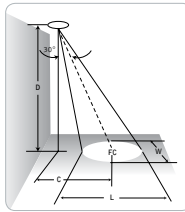

FOOTCANDLE VALUES

30° aiming angle - horizontal surface

D	C	FC	L	W
6'	3.5'	102	2.1'	1.8'
8'	4.6'	58	2.8'	2.4'
10'	5.8'	37	3.5'	3.0'
12'	6.9'	26	4.2'	3.6'
14'	8.1'	19	4.9'	4.3'

FOOTCANDLE VALUES

30° aiming angle - vertical surface

D	C	FC	L	W
2'	3.5'	303	2.2'	1.1'
3'	5.2'	137	3.3'	1.6'
4'	6.9'	78	4.4'	2.1'
5'	8.7'	49	5.6'	2.6'
6'	10.4'	34	6.7'	3.2'

Footcandle results based on AGI32; off the shelf lamp in fixture, with soft focus lens; Reflectances=0/0/0; LLF=1

Go to www.focalpointlights.com for additional photometric data.