

0-45° accent – reflector
id®

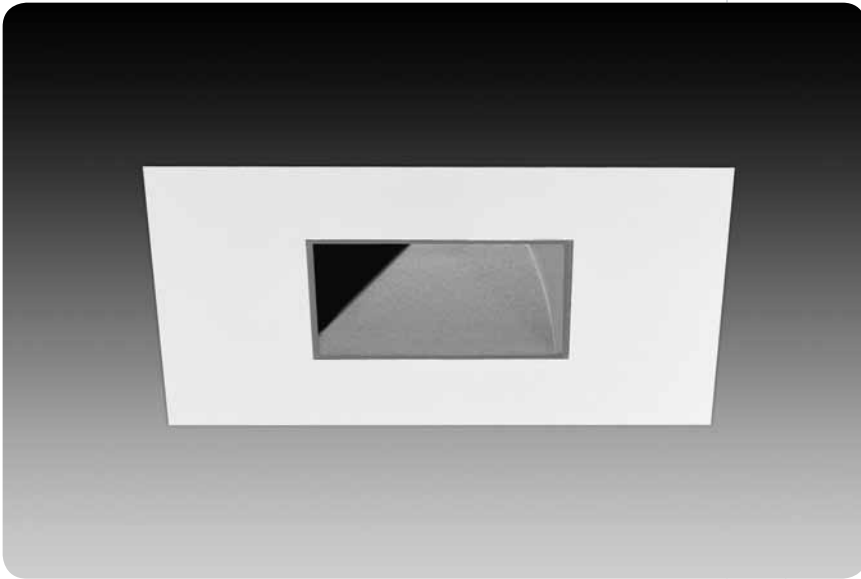

Covered by US Patent: 7,748,868

features

Trims available in Overlap flange or Flush mud-in for a seamless appearance.

Gloves Off™ hot aiming made simple with gear drive for both 45° vertical and 363° horizontal adjustment; Self locking.

Auto Memory remembers original lamp position after relamping. Lenses are independent of lamp, and remain undisturbed during relamping.

Perfect Fit™ installation process provides seamless integration in plaster, drywall and acoustical tiles, while maintaining optics in any ceiling thickness.

Adjustment mechanism provides for:

- easy relamping
- locking of both vertical and horizontal aiming
- lowers for easy lamp and lens access.

Smart Lock™ ring allows quick removal and re-assembly of trim components for field painting.

Standard white finish is field paintable.

Interchangeable lamp and trim mechanisms allow for maximum flexibility, even after luminaire is installed.

reflector options



lens accessories



trim assembly

trim with adjustment mechanism

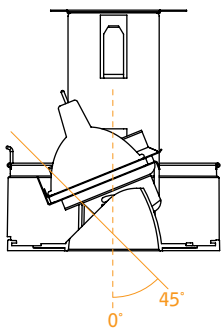

flush trim (drywall only)

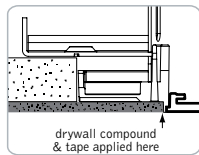
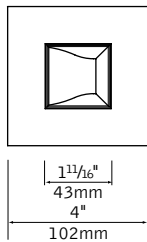

ceiling cutout dimensions: 6 3/16"

overlap trim

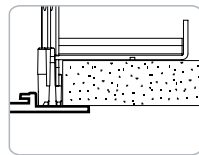
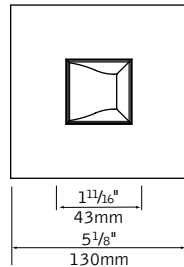

ceiling cutout dimensions: T & IC Housings - 4 11/16" RT Housing - 4 5/8"

housing types

T

14" x 7.625" x 5"h

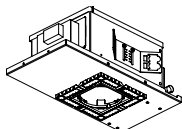

IC (air-tight)

16.5" x 10" x 9"h

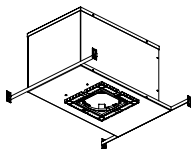

RT

12.08" x 6.32" x 5.58"h

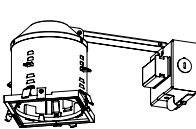

overlap faceplate only

performance

Accent Black Specular Reflector
Q71MR16/C/NSP15
4698 cd @ 30° (30° tilt)

For optimal performance, rotate lamp on axis to 0°, 90°, 180° or 270°.

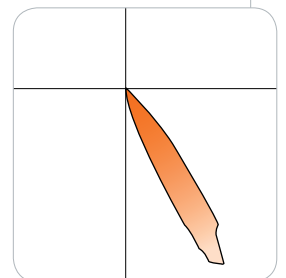

Visit focalpointlights.com for complete photometric data.

fixture:

project:

housing specifications

lamp

Halogen MR16 lamp provides numerous beam options from 10° to 40° (60° not recommended).

construction

(T)Thermally protected housing for new construction applications without direct contact with insulation. Insulation to be kept 3" away from housing. Unit is enclosed in 20ga. black painted CRS housing, which eliminates stray light into the plenum, on a 20ga. CRS frame. Housing ships standard with butterfly brackets which mount to ½ emt or channel and vertically adjust 2". Bar hangers are an option and must be specified when ordering T-rated housing. Transformer is accessible from below ceiling. Unit may be relamped from above. Fixture will not exceed 7.5lbs.

(IC) Insulated ceiling housing for new construction applications with direct insulation contact. Unit is constructed of double wall 18ga. aluminum housing on a 20ga. CRS frame. Housing ships standard with locking bar hangers. Transformers and thermal protectors are accessible from below ceiling. Housing is gasketed and complies with ASTM E-283, air-tight energy codes. Fixture will not exceed 11lbs.

(RT)Remodel, thermally protected housing for remodel construction applications without direct contact with insulation. Insulation to be kept 3" away from housing. Unit is 20ga. black painted CRS with contoured top and hinging J-box arm. Housing locks into finished ceiling via 4 removable spring clips. J-box and transformers are accessible by removing housing from ceiling. Fixture will not exceed 4.5lbs.

electrical

Porcelain bi-pin socket with #18 Teflon leads with keyed quick connection. Acoustically isolated transformer, replaceable from below, mounted outside of housing to ensure cool operation and minimize hum. Transformers available in either electronic or magnetic 120V or 277V. For residential dimming applications, toroidal magnetic transformer is available. Large junction box with pryouts. UL listed for thru branch wiring, four #12 90°C conductors for T housing and two #14 90°C conductors for RT and IC housing.

installation

Adjustable throat allows infinite adjustment for ½" to 1½" thick ceilings. Shipped in ½" ceiling position. For thicker ceilings consult factory.

Ceiling thickness adjustment sleeve locks with supplied ⅝" hex driver. Sleeve allows fine tuning of the housing for a perfect fit. Square housing allows 45° rotation to square up the edges of the trim with the architecture and adjacent trims. Comes with laser/string alignment guides.

Housing ships with dust cover.

trim specifications

aesthetics

Die cast parabolic cone ensures glare free optics. Truncated cone cut allows full tilt of lamp. CS, CD and BS are painted finishes.

Matte white finish may be used as a primer coat for field painting. Smart Lock™ ring allows disassembly for custom field painting.

adjustment mechanism

Auto Memory for relamping, lamp returns to preset aiming position

Mechanism is matte black finish, and holds lamp and lenses independently.

Ho aiming with Phillips screwdriver allows 45° vertical tilt, and 363° rotation and locks into position. Mechanism pulls down for quick and easy relamping.

Vertical angle and horizontal rotation indicators display positioning. For optimal performance, rotate lamp on axis to 0°, 90°, 180° or 270°.

Tempered soft focus lens supplied as standard.

Lens tray can hold up to three accessories, up to ⅜" thick. Lenses remain undisturbed during relamping.

optics

50° cutoff to the lamp and lamp image.

construction

Trim stays captive to housing during relamping via torsion springs.

Torsion springs pull trim tight to the ceiling and install in 90° increments.

No visible fasteners within the trim.

Mechanical light traps eliminate light leaks.

Warp free die-cast aluminum faceplate, .040" thick flange on overlap versions.

labels

UL listed, Damp label standard.

No visible labels when trim is installed.

housing ordering

housing series FD4

Halogen Housing FD4

lamp MR

MR16 Lamp MR

transformer type _____

Electronic Dimming 120V, 11.7V E1

Electronic Dimming 277V, 11.7V E2

Magnetic Dimming 120V, 11.7V M1

(T housings only)

Magnetic Dimming 277V, 11.7V M2

(T housings only)

Toroidal Dimming 120V M1T

(IC & RT housings only)

faceplate type _____

Square Flush SF

(T & IC housings only)

Square Overlap SO

housing type _____

(T Rated: 71W max.

IC Rated & Remodel: 50W max.)

New Construction T Rated, T

up to 1½" ceilings

New Construction T Rated, T2

1½" to 2½" ceilings

New Construction T Rated, T3

2½" to 3½" ceilings

New Construction IC Rated, IC

up to 1½" ceilings

New Construction IC Rated, IC2

1½" to 2½" ceilings

New Construction IC Rated, IC3

2½" to 3½" ceilings

Remodel T Rated RT

(overlap faceplate only)

factory options _____

Bar Hangers BH

(T housings only)

Wattage Restriction Label WRXX

(XX=wattage)

Chicago Plenum CP

(T housings only)

trim ordering

trim aperture D2

1½" Aperture D2

faceplate type _____

Square Flush SF

(T & IC housing only) (drywall only)

Square Overlap SO

optic AA

Adjustable Accent AA

color _____

Clear Specular CS

Clear Diffuse CD

Black Specular BS

faceplate finish _____

White WH

Black BK

Titanium Silver TS

Aluminum Raw AL

lens accessories _____

(soft focus lens supplied as standard)

Hex Louver HL

Linear Spread Lens LSL

Prismatic Spread Lens PSL

Sand Blasted Lens SBL

Clear Lens CL

UV Lens UVL

a complete unit consists of two line items, housing and trim

example: FD4-MR-E1-SF-T / D2-SF-AA-CD-WH

sqr accent – reflector
id®

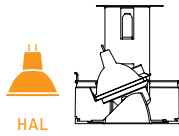

Luminaire: 71W MR16 adjustable accent, narrow spot distribution with microprismatic lens
 Filename: D2SXAACS71NS15_0.ies and D2SXAACS71NS15_35.ies
 Catalog #: D2-SX-AA-CS-WH
 Efficiency: 68% (0° tilt), 54% (35° tilt)
 Photometric Report #: 13637.0 and 13638.0

CANDLEPOWER DISTRIBUTION - 0° TILT

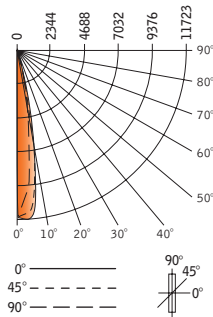

Vertical Angle	Horizontal Angle			
	0°	22.5°	45°	67.5° 90°
0°	6024	6024	6024	6024
5°	6020	5878	5718	5279 4807
15°	1155	1374	1204	1159 812
25°	78	90	143	80 57
35°	19	23	26	19 14
45°	9	9	11	7 3
55°	0	0	0	0 0
65°	0	0	0	0 0
75°	0	0	0	0 0
85°	0	0	0	0 0
90°	0	0	0	0 0

CANDLEPOWER DISTRIBUTION - 35° TILT

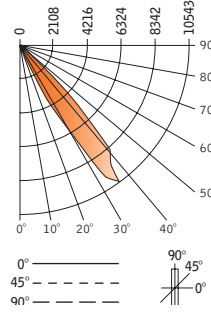

Vertical Angle	Horizontal Angle			
	0°	22.5°	45°	67.5° 90°
0°	320	320	320	320
5°	291	269	225	188 204
15°	404	337	235	142 58
25°	3241	1090	240	108 29
35°	10543	1420	71	16 10
45°	3706	285	29	3 0
55°	79	26	5	0 0
65°	10	0	0	0 0
75°	0	0	0	0 0
85°	0	0	0	0 0
90°	0	0	0	0 0

FOOTCANDLE VALUES
0° aiming angle - horizontal surface

D	C	FC	L	W
6'	0	168	1.6'	1.6'
8'	0	94	2.1'	2.1'
10'	0	60	2.6'	2.6'
12'	0	42	3.2'	3.2'
14'	0	31	3.7'	3.7'

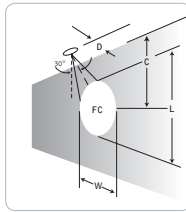
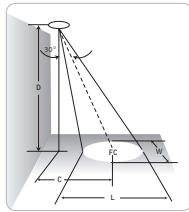

FOOTCANDLE VALUES
35° aiming angle - horizontal surface

D	C	FC	L	W
6'	4.2'	134	2.4'	1.9'
8'	5.6'	73	3.2'	2.6'
10'	7'	48	4'	3.2'
12'	8.4'	32	4.8'	3.9'
14'	9.8'	24	5.5'	4.5'

FOOTCANDLE VALUES
35° aiming angle - vertical surface

D	C	FC	L	W
2'	2.9'	382	1.6'	.9'
3'	4.3'	175	2.5'	1.4'
4'	5.7'	100	3.3'	1.8'
5'	7.1'	62	4.1'	2.3'
6'	8.6'	44	5'	2.8'

Footcandle results based on AG132; off the shelf lamp in fixture, with soft focus lens; Reflectances=0/0/0; LLF=1

Go to www.focalpointlights.com for additional photometric data.

sqr accent – reflector
id®

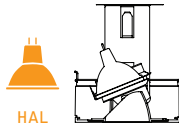

Luminaire: 71W MR16 adjustable accent, narrow spot distribution with microprismatic lens
 Filename: D2SXAABSHA71NS15_0.ies and D2SXAABSHA71NS15_30.ies
 Catalog #: D2-SX-AA-BS-WH
 Efficiency: 71% (0° tilt), 56% (30° tilt)
 Photometric Report #: 13569.0 and 13570.0

CANDLEPOWER DISTRIBUTION - 0° TILT

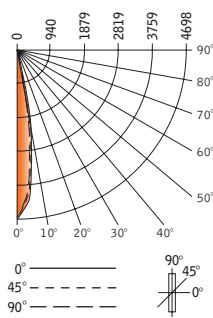

Vertical Angle	Horizontal Angle			
	0°	22.5°	45°	67.5° 90°
0°	5192	5192	5192	5192
5°	4388	4631	4595	4586 4531
15°	1046	1127	1250	1170 1209
25°	154	218	261	186 107
35°	18	25	30	15 12
45°	8	8	8	6 4
55°	1	1	0	0 0
65°	0	0	0	0 0
75°	0	0	0	0 0
85°	0	0	0	0 0
90°	0	0	0	0 0

CANDLEPOWER DISTRIBUTION - 30° TILT

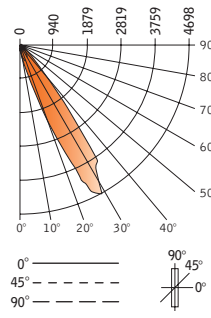

Vertical Angle	Horizontal Angle			
	0°	22.5°	45°	67.5° 90°
0°	153	153	153	153
5°	236	209	191	168 144
15°	844	705	372	183 95
25°	3605	1976	523	126 41
35°	3869	1524	201	26 8
45°	563	256	27	4 0
55°	48	21	6	0 0
65°	4	3	0	0 0
75°	0	0	0	0 0
85°	0	0	0	0 0
90°	0	0	0	0 0

FOOTCANDLE VALUES
0° aiming angle - horizontal surface

D	C	FC	L	W
6'	0	145	1.6'	1.6'
8'	0	81	2.1'	2.1'
10'	0	52	2.6'	2.6'
12'	0	36	3.2'	3.2'
14'	0	27	3.7'	3.7'

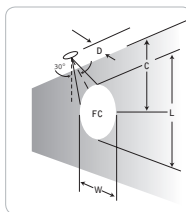
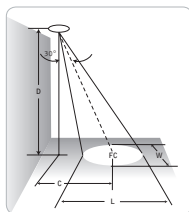

FOOTCANDLE VALUES
30° aiming angle - horizontal surface

D	C	FC	L	W
6'	3.5'	83	2.1'	1.8'
8'	4.6'	48	2.8'	2.4'
10'	5.8'	30	3.5'	3.0'
12'	6.9'	21	4.2'	3.6'
14'	8.1'	16	4.9'	4.3'

FOOTCANDLE VALUES
30° aiming angle - vertical surface

D	C	FC	L	W
2'	3.5'	251	2.2'	1.1'
3'	5.2'	13	3.3'	1.6'
4'	6.9'	64	4.4'	2.1'
5'	8.7'	40	5.6'	2.6'
6'	10.4'	28	6.7'	3.2'

Footcandle results based on AG132; off the shelf lamp in fixture, with soft focus lens; Reflectances=0/0/0; LLF=1

Go to www.focalpointlights.com for additional photometric data.