

grid
seem® 4 asymmetric



features

Narrow 4" asymmetric slot wall wash fluorescent that integrates luminaire with ceiling for clean unobtrusive aesthetic.

Precision micro-optic delivers shadow free illumination from ceiling to floor.

Allows for individual or continuous row mount in grid ceilings

Available in 1 lamp T5 or T5H0 configurations.

Delivers high levels of vertical illumination to highlight artwork, white boards or displays.

dimensional data

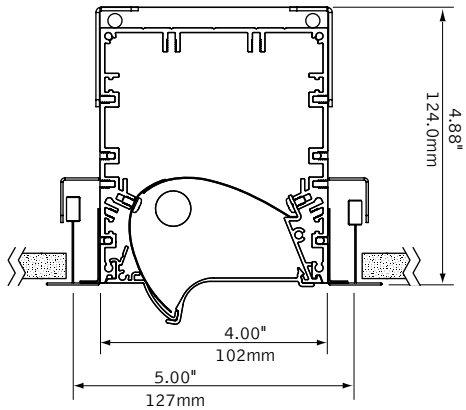

shielding options

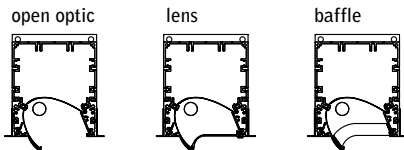

shielding options



companion luminaires

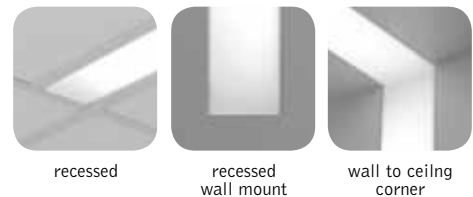

performance

1-Lamp T5H0 - No Shielding
 53% Efficiency
 1690 cd @ 20°

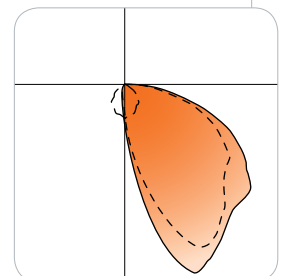

Visit focalpointlights.com for complete photometric data.

fixture:
project:

mounting information

grid

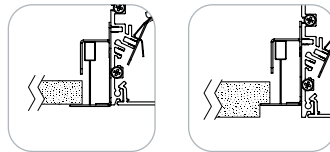
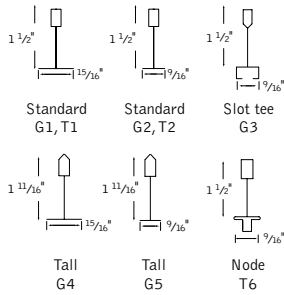

lay-in tile (G) tegular tile (T)
Luminaire always rests at level of tile.

specifications

construction

One piece, .07" thick housing of 6063-T5 extruded aluminum.
16 Ga. internal bulkhead. 20 Ga. steel end caps.
Grid Luminaires include 22 Ga. steel, .35" wide flange rail finished in Matte Satin White.
Earthquake clips standard on all grid luminaires.

2' unit weight:	18 lbs.
3' unit weight:	24 lbs.
4' unit weight:	30 lbs.
5' unit weight:	36 lbs.
6' unit weight:	43 lbs.
8' unit weight:	55 lbs.

optic

.020" specular aluminum upper reflector and 0.20" semi-specular lower reflector.
Matte black extruded aluminum diffuser.
24 Ga. Steel Radial cut off baffle.

electrical

Luminaires are pre-wired with factory installed branch circuit wiring and over-molded quick connects.
Electronic fluorescent ballasts are thermally protected and have a Class "P" rating.
Optional dimming ballasts available.
UL and cUL listed.

finish

Polyester powder coat applied over a 5-stage pre-treatment.

ordering

luminaire series FSM4A
Seem 4 Asymmetric FSM4A

shielding
No Shielding, Open Optic NS
Snap-in Clear Lens CL
Radial Cut-Off Baffle RL
(Baffle always painted white)

lampping
One Lamp T5 1T5
One Lamp T5H0 1T5H0

circuits 1C
Single Circuit 1C

voltage
120 Volt 120
277 Volt 277
347 Volt 347

ballast
Electronic Program Start <10% THD S
Electronic Dimming Ballast* D

ceiling configuration
Std. 15/16" Lay-in G1
Std. 15/16" Tegular T1
Std. 9/16" Lay-in G2
Std. 9/16" Tegular T2
9/16" Slot-tee Tegular G3
Tall 15/16" Lay-in G4
Tall 15/16" Lay-in T4
Tall 9/16" Lay-in G5
Tall 9/16" Lay-in T5
Node 9/16" Tegular T6

factory options
Chicago Plenum CP
Emergency Circuit* EC
Emergency Battery Pack* EM
Flex Whip* FW
HLR/GLR Fuse FU
Include 3000K lamp L830
Include 3500K lamp L835
Include 4100K lamp L841

finish WH
Matte White WH

luminaire length
(designed to fit standard grid lengths)
Specify luminaire/row length in 1' increments (consult factory for 5' dimming) X'

recessed asymmetric - drywall/grid
seem™ 4



Filename: FSM4ANS1T5H0.IES
Catalog #: FSM4A-NS-1T5H0-1C-120-S-G1-WH-4'
Efficiency: 53%
Test #: 16062.0

CANDLEPOWER DISTRIBUTION

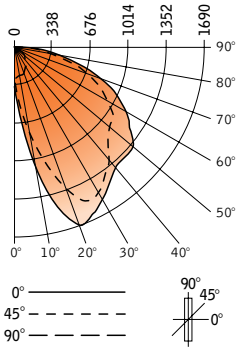

Vertical Angle	Horizontal Angle				Zonal Lumens
	0°	22.5°	45°	67.5°	
0°	289	289	289	289	289
5°	663	613	523	403	268
15°	1459	1363	1064	659	255
25°	1652	1636	1509	930	223
35°	1488	1480	1415	1111	199
45°	1401	1305	1185	1052	139
55°	1264	1226	1083	857	105
65°	1012	984	858	609	58
75°	637	613	537	403	31
85°	268	252	203	128	7
90°	142	128	88	32	0
95°	0	0	0	0	0
105°	0	0	0	0	0
115°	0	0	0	0	0
125°	0	0	0	0	0
135°	0	0	0	0	0
145°	0	0	0	0	0
155°	0	0	0	0	0
165°	0	0	0	0	0
175°	0	0	0	0	0
180°	0	0	0	0	0

LUMEN SUMMARY

	Zone Lumens	% Lamp	% Fixt	
0°-30°	506	10.1	19.0	
0°-40°	930	18.6	34.9	
0°-60°	1883	37.7	70.7	
0°-90°	2665	53.3	100.0	
Total Luminaire	0°-180°	2665	53.3	100

CO-EFFICIENTS OF UTILIZATION

Floor	80				70				20						
Ceiling	50				30				10						
Wall	70	50	30	10	70	50	10	50	10	50	10	50	10	50	10
RCR 0	63	63	63	63	62	62	62	59	59	57	57	54	54	53	53
1	57	55	522	50	56	53	49	51	47	49	46	47	45	43	43
2	52	47	43	40	50	46	39	44	38	42	37	41	37	35	35
3	47	41	36	33	43	40	32	39	32	37	31	36	31	29	29
4	43	36	31	27	41	35	27	34	26	33	26	31	26	25	25
5	39	31	26	22	37	31	22	29	22	28	22	27	21	20	20
6	35	28	22	19	34	27	19	26	18	24	18	24	18	17	17
7	32	24	19	16	31	24	16	23	16	22	16	22	15	14	14
8	29	22	17	13	29	21	13	20	13	20	13	19	13	12	12
9	27	19	14	11	26	19	11	18	11	18	11	17	11	10	10
10	25	17	13	10	24	17	10	16	10	16	10	15	9	8	8

Numbers indicate percentage values of reflectivity.

Go to www.focalpointlights.com for additional photometric data.

recessed asymmetric - drywall/grid
seem™ 4



Filename: FSM4ARL1T5H0.IES
Catalog #: FSM4A-RL-1T5H0-1C-120-S-G1-WH-4'
Efficiency: 45%
Test #: 16063.0

CANDLEPOWER DISTRIBUTION

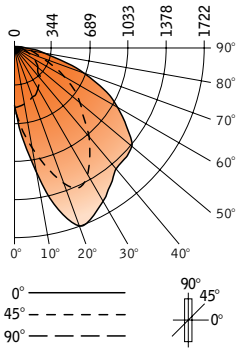

Vertical Angle	Horizontal Angle				Zonal Lumens
	0°	22.5°	45°	67.5°	
0°	546	546	546	546	546
5°	812	793	725	632	533
15°	1509	1413	1129	793	509
25°	1681	1593	1395	892	465
35°	1517	1382	1190	899	399
45°	1415	1157	883	678	294
55°	1229	976	661	46	230
65°	880	644	365	215	151
75°	429	303	179	127	83
85°	116	106	79	49	21
90°	69	65	44	21	0
95°	0	0	0	0	0
105°	0	0	0	0	0
115°	0	0	0	0	0
125°	0	0	0	0	0
135°	0	0	0	0	0
145°	0	0	0	0	0
155°	0	0	0	0	0
165°	0	0	0	0	0
175°	0	0	0	0	0
180°	0	0	0	0	0

LUMEN SUMMARY

	Zone Lumens	% Lamp	% Fixt	
0°-30°	603	12.1	27.1	
0°-40°	1026	20.5	46.1	
0°-60°	1812	36.2	81.4	
0°-90°	2225	44.5	100.0	
Total Luminaire	0°-180°	2225	44.5	100

CO-EFFICIENTS OF UTILIZATION

Floor	80				70				20						
Ceiling	50				30				10						
Wall	70	50	30	10	70	50	10	50	10	50	10	50	10	50	10
RCR 0	53	53	53	53	52	52	52	49	49	47	47	45	45	45	45
1	49	47	45	44	48	46	43	44	41	42	40	41	39	38	38
2	45	41	39	36	44	41	36	39	35	38	34	36	33	33	33
3	41	37	33	31	40	36	30	35	30	34	29	32	29	28	28
4	38	33	29	26	37	32	26	31	26	30	25	29	25	24	24
5	34	29	25	22	34	28	22	27	22	27	22	26	21	20	20
6	32	26	22	19	31	25	19	25	19	24	19	23	19	18	18
7	29	23	19	17	28	23	16	22	16	21	16	21	16	15	15
8	27	21	17	14	26	20	14	20	14	19	14	19	14	13	13
9	25	18	15	12	24	18	12	18	12	17	12	17	12	11	11
10	23	17	13	11	22	16	11	16	11	16	11	15	10	10	10

Numbers indicate percentage values of reflectivity.

Go to www.focalpointlights.com for additional photometric data.