

drywall with regressed lens

# seem® 4



### features

Narrow 4" aperture slot fluorescent luminaire that integrates with the ceiling for a clean unobtrusive aesthetic.

Frosted acrylic regress lens provides even illumination, high performance lens also available for increased efficiency.

Allows for individual and continuous row mount in trimless or flanged drywall applications.

Available in 1 lamp T5, T5H0 or T8, and 2 lamp T5 configurations, Seem 4 provides continuous illumination by combining 3' and 4' staggered lamps. Specify 1 lamp for even appearance and minimal lamp image, or 2 lamps when higher light levels are required.

### dimensional data

#### trimless mud-in

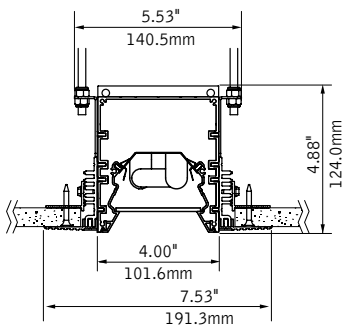

note: 0.375"min - 2.125"max ceiling thickness

#### trim flange

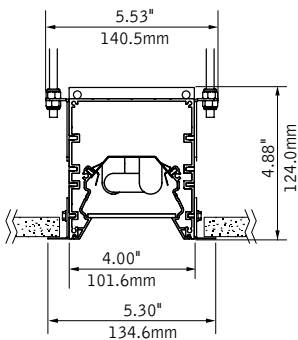

### companion luminaires

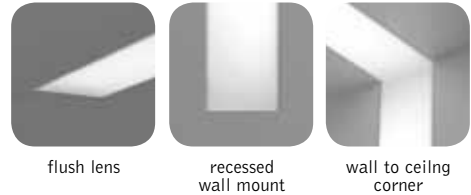

flush lens

recessed wall mount

wall to ceiling corner

### performance

1-Lamp T5H0  
Regressed High Performance Lens  
65% Efficiency  
1451 cd @ 0°

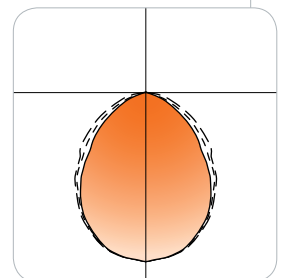

Visit [focalpointlights.com](http://focalpointlights.com) for complete photometric data.

fixture:  
project:

### mounting information

trim flange before drywall

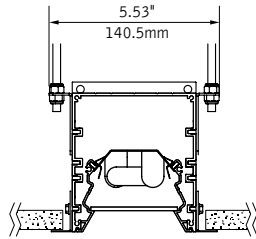

trim flange after drywall

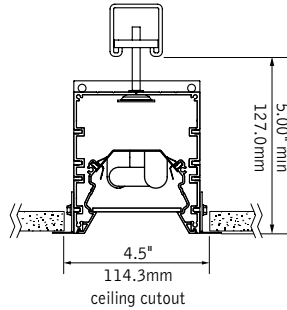

Notes: All trim flange mounting styles for new construction only.  
Mounting hardware by others see instruction sheet for specific information.

### specifications

#### construction

One piece, .07" thick housing of 6063-T5 extruded aluminum.  
16 Ga. internal bulkhead. 20 Ga. steel end caps.  
Luminaires include trimless aluminum flange.  
Lengths 6' and longer configured with staggered lamps:

1-lamp T8: 4.47" overlap  
1-lamp T5/T5HO: 4.35" overlap  
2-lamp T5: 2.00" overlap

2' unit weight: 18 lbs.  
3' unit weight: 24 lbs.  
4' unit weight: 30 lbs.  
5' unit weight: 36 lbs.  
6' unit weight: 43 lbs.  
8' unit weight: 55 lbs.

#### optic

Reflectors fabricated of 22 Ga. Steel finished in High Reflectance White powder coat.  
Standard regressed lens (SR): Frosted Acrylic lens, .118" thick.  
Regressed high performance lens (SRXP): Frosted Acrylic lens, .118" thick with increased light transmission.

#### electrical

Luminaires are pre-wired with factory installed branch circuit wiring and over-molded quick connects.  
Electronic fluorescent ballasts are thermally protected and have a Class "P" rating.  
Optional dimming ballasts available.  
UL and cUL listed.

#### finish

Polyester powder coat applied over a 5-stage pre-treatment.

### ordering

luminaire series FSM4  
Seem 4 FSM4

shielding \_\_\_\_\_  
Regressed Lens SR  
Regressed High Performance Lens SRXP

lamping \_\_\_\_\_  
One Lamp T8 1T8  
One Lamp T5 1T5  
Two Lamp T5 2T5  
One Lamp T5HO 1T5HO

circuits \_\_\_\_\_  
Single Circuit 1C  
Dual Circuit 2C (2 lamp T5 only)

voltage \_\_\_\_\_  
120 Volt 120  
277 Volt 277  
347 Volt 347

ballast \_\_\_\_\_  
Electronic Instant Start <20% THD (T8 only) E  
Electronic Program Start <10% THD S  
Electronic Dimming Ballast\* D

mounting \_\_\_\_\_  
Trim Flange Drywall TF  
Mud-in Trimless, pre-set for 1/2" Drywall XF1  
Mud-in Trimless, pre-set for 5/8" Drywall XF2  
Mud-in Trimless, set thickness in field (mounting equipment assembled in field) XFF

factory options \_\_\_\_\_  
Chicago Plenum CP  
Emergency Circuit\* EC  
Emergency Battery Pack\* EM  
Flex Whip\* FW  
HLR/GLR Fuse FU  
Include 3000K lamp L830  
Include 3500K lamp L835  
Include 4100K lamp L841

finish WH  
Matte White WH

luminaire length \_\_\_\_\_  
(lengths are nominal)  
Specify luminaire/row length in 1' increments (lengths 6' and longer configured with staggered lamps.) (Consult factory for 5' dimming) X'

\* for more information see Reference section.

recessed regress lens  
seem® 4



Filename: FSM4SRXP1T5H.IES  
Catalog #: FSM4-SRXP-1T5H0-1C-120-S-G1-WH-4'  
Efficiency: 65%  
Test #: 16220.0

CANDLEPOWER DISTRIBUTION

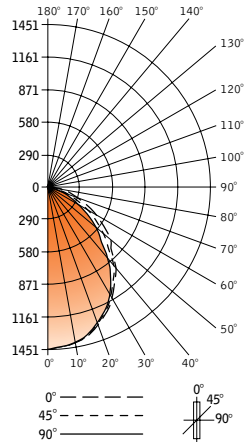

Spacing 1.2  
Criterion: 1.2

Vertical Angle	Horizontal Angle				Zonal Lumens
	0°	22.5°	45°	67.5°	
0°	1451	1451	1451	1451	1451
5°	1437	1436	1434	1436	1434
15°	1378	1377	1375	1371	1371
25°	1248	1244	1236	1224	1220
35°	1052	1047	1028	1001	981
45°	812	803	764	699	673
55°	619	607	530	466	443
65°	395	372	297	249	235
75°	191	158	111	84	75
85°	43	19	16	16	15
90°	0	0	0	0	0
95°	0	0	0	0	0
105°	0	0	0	0	0
115°	0	0	0	0	0
125°	0	0	0	0	0
135°	0	0	0	0	0
145°	0	0	0	0	0
155°	0	0	0	0	0
165°	0	0	0	0	0
175°	0	0	0	0	0
180°	0	0	0	0	0

LUMEN SUMMARY

Zone	Lumens	% Lamp	% Fixt	
0°-30°	1098	22.0	33.7	
0°-40°	1741	34.8	53.4	
0°-60°	2802	56.0	86.0	
0°-90°	3258	65.2	100	
<b>Total Luminaire</b>	<b>0°-180°</b>	<b>3258</b>	<b>65.2</b>	<b>100</b>

LUMINANCE DATA (CD/M<sup>2</sup>)

Vertical Angle	0°	45°	90°
45°	11120	10463	9217
55°	10451	8948	7479
65°	9051	6805	5385
75°	7146	4153	2806
85°	4778	1778	1667

CO-EFFICIENTS OF UTILIZATION

Floor	80	70	50	30	10	00
RCR 0	78 78 78 78	76 76 76	72 72	69 69	66 66	65
1	72 70 67 65	71 68 64	66 62	63 60	61 59	57
2	67 62 59 55	65 61 55	59 54	57 52	55 51	50
3	62 56 51 48	60 55 47	53 46	51 46	50 45	44
4	57 50 45 41	56 49 41	48 40	46 40	45 39	38
5	52 45 40 36	51 44 35	43 35	42 35	40 34	33
6	48 40 35 31	47 40 31	39 31	38 31	37 30	29
7	45 37 31 28	44 36 27	35 27	34 27	33 27	26
8	41 33 28 24	40 33 24	32 24	31 24	30 24	22
9	38 30 24 21	37 29 21	29 21	28 21	27 21	19
10	35 27 22 19	35 27 19	26 19	25 18	25 18	17

Go to [www.focalpointlights.com](http://www.focalpointlights.com) for additional photometric data.

recessed regress lens  
seem® 4



Filename: FSM4SR1T5H.IES  
Catalog #: FSM4-SR-1T5H0-1C-120-S-G1-WH-4'  
Efficiency: 59.4%  
Test #: 16221.0

CANDLEPOWER DISTRIBUTION

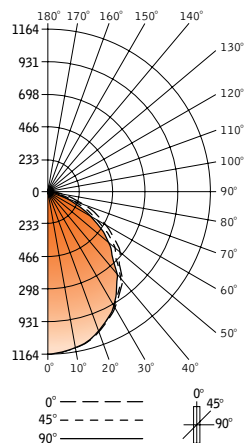

Spacing 1.2  
Criterion: 1.2

Vertical Angle	Horizontal Angle				Zonal Lumens
	0°	22.5°	45°	67.5°	
0°	1164	1164	1164	1164	1164
5°	1152	1150	1150	1150	1149
15°	1111	1111	1111	1109	1109
25°	1026	1026	1025	1022	1019
35°	899	898	890	878	866
45°	735	729	705	670	655
55°	596	588	537	495	478
65°	403	382	324	282	267
75°	203	170	12	87	77
85°	45	18	16	15	15
90°	0	0	0	0	0
95°	0	0	0	0	0
105°	0	0	0	0	0
115°	0	0	0	0	0
125°	0	0	0	0	0
135°	0	0	0	0	0
145°	0	0	0	0	0
155°	0	0	0	0	0
165°	0	0	0	0	0
175°	0	0	0	0	0
180°	0	0	0	0	0

LUMEN SUMMARY

Zone	Lumens	% Lamp	% Fixt	
0°-30°	898	18.0	30.3	
0°-40°	1456	29.1	49.0	
0°-60°	2481	49.6	83.6	
0°-90°	2969	59.4	100	
<b>Total Luminaire</b>	<b>0°-180°</b>	<b>2969</b>	<b>59.4</b>	<b>100</b>

LUMINANCE DATA (CD/M<sup>2</sup>)

Vertical Angle	0°	45°	90°
45°	10066	9655	8970
55°	10062	9066	8070
65°	9234	7424	6118
75°	7595	4665	2881
85°	5000	1778	1667

CO-EFFICIENTS OF UTILIZATION

Floor	80	70	50	30	10	00
RCR 0	71 71 71 71	69 69 69	66 66	63 63	61 61	59
1	66 63 61 59	64 62 58	59 56	57 55	55 53	52
2	60 56 53 50	59 55 45	53 48	51 47	49 46	45
3	56 50 46 42	54 49 42	47 41	46 40	44 40	39
4	51 45 40 36	50 44 36	42 36	41 35	40 35	33
5	47 40 35 31	46 39 31	38 30	37 30	36 30	29
6	43 36 31 27	42 35 27	34 27	33 26	32 26	25
7	40 32 27 23	39 32 23	31 23	30 23	29 23	22
8	37 29 24 20	36 28 20	28 20	27 20	26 20	19
9	34 26 21 18	33 25 18	25 18	24 17	23 17	16
10	31 23 19 16	31 23 16	23 16	22 15	21 15	14

Go to [www.focalpointlights.com](http://www.focalpointlights.com) for additional photometric data.

Numbers indicate percentage values of reflectivity.

Numbers indicate percentage values of reflectivity.

# seem® 4 & 6 run information

## EXAMPLE 16' run



### 1-T5/T5H0

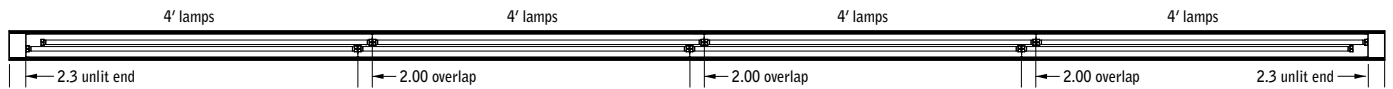

2-T5/T5H0 (may exhibit noticeable socket shadows)

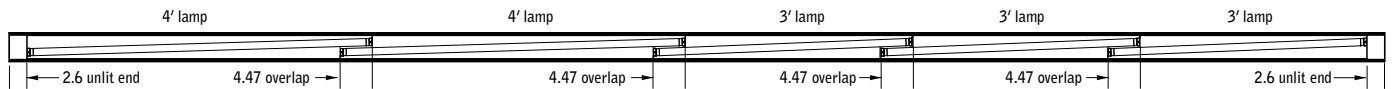

### 1-T8

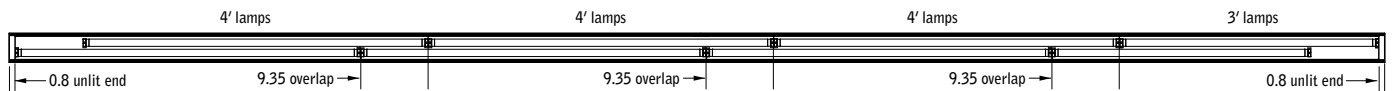

2-T8 (may exhibit noticeable socket shadows)

### notes:

- lamp overlap is consistent throughout run.
- unlit ends vary to provide even light throughout run.
- standard configurations listed, consult factory for additional options.

# seem® 4 & 6 run information

nominal run length (ft)	1-T5/T5H0 (4.35" overlap)			2-T5/T5H0 (2.00" overlap)			1-T8 (4.47" overlap)			2-T8 (9.35" overlap)		
	lamp quantity		unlit ends (in)	lamp quantity		unlit ends (in)	lamp quantity		unlit ends (in)	lamp quantity		unlit ends (in)
	3'	4'		3'	4'		3'	4'		3'	4'	
6	2		3.5	4		0.2	2		1.8	n/a	n/a	n/a
7	1	1	3.6	2	2	0.3	1	1	1.8	4		0.8
8	3		0.5		4	0.4		2	1.8	2	2	0.8
9	2	1	0.6	6		1.1	3		4.0		4	0.9
10	1	2	0.6	4	2	1.2	2	1	4.1	6		0.8
11		3	0.8	2	4	1.3	4		0.3	4	2	0.8
12	3	1	3.7		6	1.3	3	1	0.3	2	4	0.8
13	5		0.7	6	2	2.1	2	2	0.3		6	0.8
14	4	1	0.8	4	4	2.2	1	3	0.3	6	2	0.8
15	3	2	0.8	2	6	2.3		4	0.3	4	4	0.8
16	2	3	1.0		8	2.3	3	2	2.6	2	6	0.8
17	1	4	1.1	6	4	3.0	2	3	2.6		8	0.8
18		5	1.1	4	6	3.1	1	4	2.6	6	4	0.8
19	6	1	0.8	2	8	3.2	7		1.0	4	6	0.8
20	5	2	0.8		10	3.3	6	1	1.0	2	8	0.8
21	4	3	1.0	6	6	4.0	5	2	1.1		10	0.8
22	3	4	1.1	4	8	4.1	4	3	1.1	6	6	0.8
23	9		1.1	2	10	4.2	3	4	1.1	4	8	0.8
24	1	6	0.9		12	4.3	2	5	1.1	2	10	0.8
25	7	2	1.3	6	8	4.9	1	6	1.1		12	0.8
26	6	3	1.2	18		0.3		7	1.2	6	8	0.8
27	5	4	1.3	16	2	0.3	10		1.8	4	10	0.8
28	11		1.0	14	4	0.4	9	1	1.8	2	12	0.8
29	10	1	1.1	12	6	0.6	8	2	1.8		14	0.8
30	9	2	1.2	10	8	0.7	7	3	1.8	6	10	0.8
31	8	3	1.3		16	0.2	6	4	1.8	4	12	0.8
32	7	4	1.4	6	12	0.8	5	5	1.8	2	14	0.8
33	13		1.2	4	14	0.9	4	6	1.8		16	0.8
34	12	1	1.2	2	16	1.1	3	7	1.9	6	12	0.8
35	11	2	1.3		18	1.1	2	8	1.9	4	14	0.8
36	10	3	1.4	6	14	1.8	1	9	1.9	2	16	0.8
37	9	4	1.5	4	16	1.9	7	5	0.3		18	0.9
38	15		1.3	2	18	2.0	6	6	0.3	6	14	0.8
39	14	1	1.3		20	2.1	5	7	0.4	4	16	0.8
40	13	2	1.4	6	16	2.8	4	8	0.4	2	18	0.8
41	12	3	1.6	4	18	2.8	3	9	0.4		20	0.9
42	4	11	1.7	2	20	2.9	2	10	0.4	6	16	0.8
43	5	10	1.8		22	3.1	1	11	0.4	4	18	0.9
44	9	6	1.9	6	18	3.7		12	0.4	2	20	0.9
45	8	7	1.9	4	20	3.8	3	10	2.7		22	0.9
46	7	8	2.1	2	22	3.9	2	11	2.7	6	18	0.9
47	13	4	1.8		24	4.0	1	12	2.7	4	20	0.9
48	19		1.5	6	20	4.6	7	8	1.1	2	22	0.9