

vision™ II



features

2' and 4' recessed luminaire designed to address lighting requirements for videoconferencing and distance learning applications.

Continuous row installation in grid ceiling systems is easily achieved.

Vision™ II delivers superior facial modeling performance.

Highly reflective matte louver finish controls brightness and provides excellent glare management.

Vision™ II is an essential part of videoconferencing lighting systems.

dimensional data

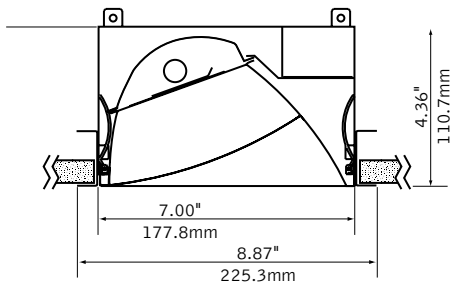

lamping options

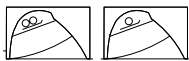

T5/T5H0 LAMPS

mounting distance from participant to center of fixture

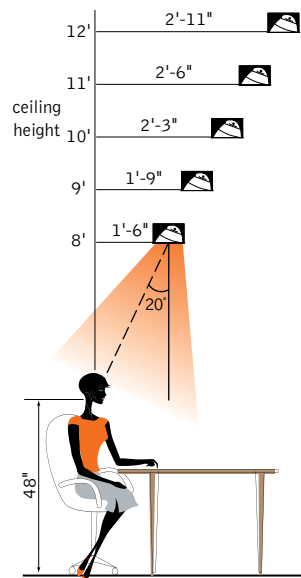

performance

1-Lamp T5H0
58% Efficiency
3148 cd @ 20°

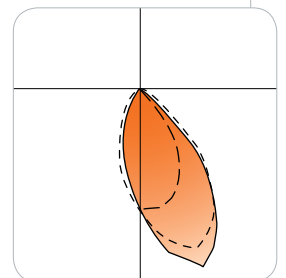

Visit focalpointlights.com for complete photometric data.

fixture:

project:

mounting information

grid

specify "G" for flat 9/16" and 15/16" tee or "ST" for 9/16" slot tee grid types.

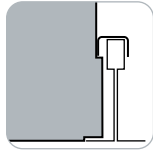

"G" flat tee

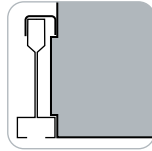

"ST" slot tee

drywall frame kit

specify "DF" Drywall Frame Kit for drywall ceiling conditions.

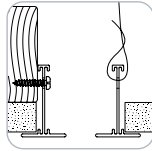

Use tie-wire or screws to secure frame kit.

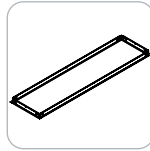

cut out dimensions:
 7': Min: 8.685"
 Max: 9.00"
 4': Min: 48.25"
 Max: 48.563"

specifications

construction

One-piece 20 Ga. steel housing.
 20 Ga. steel ceiling trim.

2' unit weight: 8 lbs.
 4' unit weight: 12 lbs.

optic

Radial parabolic louver: 2.17"H x 3.28" frequency.
 Asymmetric radial parabolic louver and reflector fabricated of low iridescent, glare-controlling, premium grade aluminum.

electrical

Electronic ballasts are thermally protected and have a Class "P" rating.
 Optional dimming ballasts available.
 Consult factory for dimming specifications and availability.
 UL and cUL listed.

finish

Polyester powder coat applied over a 5-stage pre-treatment.

ordering

luminaire series		<u>FTV</u>
Vision II	FTV	
nominal size		
4" x 7" x 2'	472	
4" x 7" x 4'	474	
distribution		<u>W</u>
Direct Asymmetrical	W	
lamp quantity		
One Lamp	1	
Two Lamps	2	
lamp type		
T5	T5	
T5HO	T5HO	
ballast		
Electronic Program Start <10% THD	S	
Electronic Dimming Ballast*	D	
voltage		
120 Volt	120	
277 Volt	277	
347 Volt	347	
mounting		
Grid	G	
Slot Tee	ST	
shielding		<u>PL</u>
Radial Parabolic Louver	PL	
factory options		
Chicago Plenum	CP	
Drywall Frame Kit (Cut out dimensions: Min: 8.685"/Max: 9.00" Min: 48.25"/Max 48.563")	DF	
Emergency Battery Pack*	EM	
HLR/GLR Fuse	FU	
Flex Whip*	FW	
Include 3000K Lamp*	L830	
Include 3500K Lamp*	L835	
Include 4100K Lamp*	L841	
Separate Circuit*	SC	
Separate Circuit Tandem*	SCT	
Labor Saving Master Satellite*	LS	
Ballast Saving Tandem*	BST	
Lutron™ Sensor Feed* (EcoSystem ballast required)	SF	
finish		<u>HW</u>
High Reflectance White	HW	

* for more information see Reference section.

vision™ II

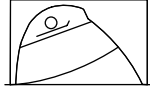

Filename: FTV4741T5HPL.IES
 Catalog #: FTV-474-W-1T5H0-S-120-G-PL-HW
 Efficiency: 58%
 Test #: 11994.0

CANDLEPOWER DISTRIBUTION

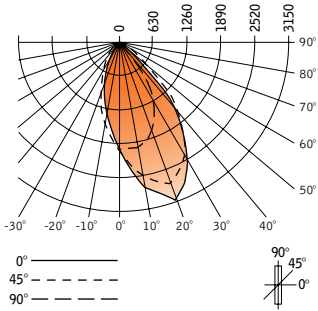

Vertical Angle	Horizontal Angle					Zonal Lumens
	0°	22.5°	45°	67.5°	90°	
0°	2021	2021	2021	2021	2021	
5°	2402	2363	2273	2139	1988	192
15°	2914	2858	2688	2352	1929	550
25°	2939	2908	2674	2192	1580	789
35°	2148	2227	2186	1679	994	738
45°	1158	1338	1379	933	360	483
55°	174	235	486	232	36	110
65°	20	30	38	20	7	14
75°	4	4	4	4	4	5
85°	1	1	1	1	1	2
90°	0	0	0	0	0	0
95°	0	0	0	0	0	0
105°	0	0	0	0	0	0
115°	0	0	0	0	0	0
125°	0	0	0	0	0	0
135°	0	0	0	0	0	0
145°	0	0	0	0	0	0
155°	0	0	0	0	0	0
165°	0	0	0	0	0	0
175°	0	0	0	0	0	0
180°	0	0	0	0	0	0

LUMEN SUMMARY

Zone	Lumens	% Lamp	% Fixt	
0°-30°	1535	30.7	53.2	
0°-40°	2273	45.5	78.8	
0°-60°	2866	57.3	99.3	
0°-90°	2886	57.7	100.0	
Total Luminaire	0°-180°	2886	58	100.0